

KOSMO LOW-PROFILES



STANDARD KOSMO LOW-PROFILES DATA

Standard chassis		Fiat Ducato 35 Light
Engine displacement	cc	2.287
Maximum power	kW (hp)	88 (120)
Towable mass ^(H)	kg	2,000
Fresh water tank capacity (antifreeze) ^(K)	l	90 + 20
Waste water recovery tank capacity	l	90
Hot air channeled heating system	kW	6

Model shown: Kosmo 512





CHASSIS

- Fiat Ducato mechanics, Turbo Diesel Common Rail, Euro 6d Temp
- Driving cab and bumpers painted in same colour
- Front wheel drive
- Enlarged rear track
- Electronic Stability Control: ESP specific for campers, ABS, ASR, Hill Holder and Roll Over Mitigation
- Front and rear sway bar
- 6-speed + 1 manual gearbox
- Driver airbag
- Diesel tank 75 l
- Electrical power windows in cab
- Day lights built into headlights and levellers
- 12 V and USB outlet in cab (max 180 W)
- Cab seating with armrests, seatbelts, adjustable in height (only driver's cab seat), backrest and fabric coordinated with living room
- Adjustable height steering wheel

DESIGN & BODYWORK

- Walls and roof highly insulated with EPS polystyrene foam, roof lined in hail protection fibreglass, aluminium external walls, anti-yellowing
- Fibreglass sub-floor for maximum resistance to gravel and weathering over time
- Automotive headlights, rear side skirts consisting of more pieces to make repair works easier"
- High quality, flat frame windows with aluminium frame, blind and mosquito net
- Premium XL living space door with centralised closure, remote control, window, blind, storage compartment and sliding mosquito net
- Aluminium underbody skirts
- External LED light
- Centralised door closure with remote control
- Garage with 150 kg payload capacity, low floor with non-slip coating, lighting, heating, rails with load hooks that can be repositioned as required, power socket, double external and internal access door
- 1 Piece front windshield in fibreglass with maxi roof-light integrated

KITCHEN & BATHROOM

- Trivalent 140 l refrigerator with automatic energy source selection (AES)
- Scratch and fingerprint resistant kitchen and table tops
- Kitchen window design panel
- Dark glass protection panels for kitchen walls
- High gloss white kitchen furniture with storage space and internal shelves with anti-fall edge
- Chromed sink in stainless steel sink with sink cover including chopping board that can also be used as an additional wall shelf (depending on the version)
- Indirect lighting under kitchen top
- 3-burner stove in stainless steel with tempered glass lid
- Automatic soft-close drawers
- Chrome metal spice rack shelf
- 230 V outlet in kitchen
- 40 x 40 cm roof-light in kitchen
- Toilet with swivel cup and removable cassette 18 litres (frost-resistant)
- Bathroom door also to be used as a separation for the centre of the passenger compartment (Kosmo 509, 509L, 512)
- Multifunctional toilet with thermoformed furniture for easy cleaning (Kosmo 209)
- Separable shower enclosure and rotation of the washbasin wall (Kosmo 209)

SYSTEMS

- 100% LED lighting
- Large floor storage compartment (Kosmo 509, 509L, 512)
- Heating 6kW and boiler with heat distribution and ducting throughout the interior
- Two USB outlets in the rear bedroom and one USB outlet in the living area
- Area for recharging mobile phones and tablets at the entrance
- Electrical system with automatic battery charger 18 A, maintenance-free high-performance service battery 95 A, on-board control panel with LED display
- Gas compartment for two 10 kg cylinders, steel gas pipes, safety isolating valves
- Internal potable water tank, 110 l capacity, easily accessible for cleaning and inspection, high-capacity electric immersion water pump
- Exhaust pipes with anti-odour siphons, recovery tank complete with external vent

INTERIOR & COMFORT

- Entrance area with large integrated step and courtesy handle
- Multi-level indirect lighting in driving cab and lounge
- Internal height up to 213 cm
- Furniture design Pero Toscano
- Noto upholstery and boat style curtains
- Hanging doors in glossy white design, metal handles and high quality mechanical components
- Living room with upholstery and home comforts, adjustable headrests and cushions with removable lining
- Face-to-face living for Kosmo 509L and 512
- Anti-condensation walls and ventilation in the furniture for an ideal spread of the heat generated by the heating system
- Ergonomic table with moving top and easy handling. Folding table top for Kosmo 509L and 512
- 70x50 cm roof-light in living area (b)
- Maxi panoramic roof-light in the front windshield
- Shoe compartment at living space entry (Kosmo 509)
- Nautical centre rear bed with manual height adjustment
- Rear beds with wooden staves, high quality, breathable mattresses with machine washable stretch lining
- Adjustable reading lights on rear beds
- Roof-light with transparent dome above rear bedroom
- Padded rear headboard
- Rear bedroom separated by courtesy curtain (Kosmo 209, 509)
- Rear bedroom separated by sliding door (Kosmo 509L, 512)
- Storage compartments and indirect lighting inside the overcabin

STANDARD SETTINGS FOR:

- Tow hitch
- Reversing camera
- TV in living area
- Satellite aerial

(b) With foldaway bed over living area, the 50x70 cm roof-light will be replaced with a 40x40 cm roof-light.

OVERVIEW OF ALL MODELS

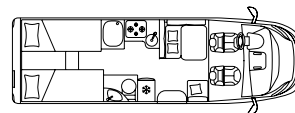
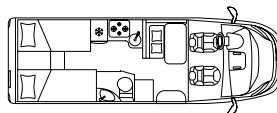

MODELS

209

509

External length / width / height ^{(D) (E)}	cm	695 / 233 / 290	741 / 233 / 290
Internal width / height	cm	218 / 213	218 / 213
Wheelbase	mm	3.800	4.035
Weight in running order ^(J)	kg	2.845	2.960
Payload (approx.) ^(F)	kg	655 ^S / 805 ^O	540 ^S / 690 ^O
Maximum total weight	kg	3.500 ^S / 3.650 ^O	3.500 ^S / 3.650 ^O
Type-approved seats ^(B)		4 ^S	4 ^S / 5 ^O
Wall / roof / floor (thickness)	mm	34 / 33 / 49	34 / 33 / 49
Garage dimensions (W x H x L)	cm	218 x 120 x 91	218 x 121 x 109
Right hatch / left hatch (W x H)	cm	75 x 115 / 75 x 115	93 x 115 / 93 x 115
Berths		2 ^S + 2 ^O	2 ^S + 2 ^O + 1 ^O
Right side rear bed / left side rear bed	cm	201 x 80 / 186 x 80	207 x 80 / 200 x 80
Rear double bed	cm	O	O
Manually height-adjustable double rear bed with wooden staves	cm	-	-
Dinette bed	cm	-	200 x 115 ^O
Electric-powered drop-down bed above the living room ^{O (L)}	cm	200 x 140	200 x 140
Refrigerator with automatic source selection and external inspection grid	l	140	140
Transparent roof-light in bathroom	cm	28 x 28	28 x 28
12 V sockets / 230 V sockets / USB socket		2 / 5 / (1+2)	2 / 6 / (1+2)
TV sockets in living room - rear bedroom		1 / -	1 / -

OPTIONAL

Optional Chassis		Fiat Ducato 43 Heavy	Fiat Ducato 43 Heavy
Maximum power	kW (hp)	103 (140), 117 (160), 130 (180)	103 (140), 117 (160), 130 (180)
Weight in running order ^(J)	kg	2.885	3.000
Payload (approx.) ^(F)	kg	1.365 ^S / 1.515 ^O	1.250 ^S / 1.400 ^O
Maximum total weight ^(C)	kg	4.250 ^S / 4.400 ^O	4.250 ^S / 4.400 ^O

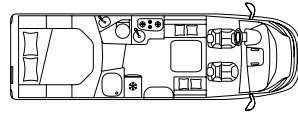
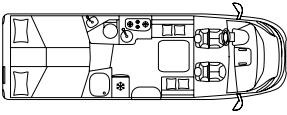

509L

741 / 233 / 290
218 / 213
4.035
2.981
519 ^S / 669 ^O
3.500 ^S / 3.650 ^O
4 ^S / 5 ^O
34 / 33 / 49
218 × 118 × 109
93 × 115 / 93 × 115
2 ^S + 2 ^O + 1 ^O
205 × 80 / 210 × 80
O
-
200 × 115 ^O
200 × 140
140
28 × 28
2 / 6 / (1+2)
1 / -
Fiat Ducato 43 Heavy
103 (140), 117 (160), 130 (180)
3.021
1.229 ^S / 1.379 ^O
4.250 ^S / 4.400 ^O

512

741 / 233 / 290
218 / 213
4.035
2.981
519 ^S / 669 ^O
3.500 ^S / 3.650 ^O
4 ^S
34 / 33 / 49
218 × 90 ^{min} / 120 ^{max} × 109
93 × 115 / 93 × 115
2 ^S + 2 ^O + 1 ^O
- / -
O
190 × 148
200 × 115 ^O
200 × 140
140
28 × 28
1 / 5 / (1+2)
1 / -
Fiat Ducato 43 Heavy
103 (140), 117 (160), 130 (180)
3.021
1.229 ^S / 1.379 ^O
4.250 ^S / 4.400 ^O



PACKS

CHASSIS PACK

+ 28,9 KG

- Manual single-zone air conditioning for cab, Fiat original part
- Traction+, Hill Descent
- Cruise control
- Electric and heated rear view mirrors
- Height adjustable passenger's cab seat, Fiat original part
- Provision for DAB radio and cab loudspeakers
- Radio DAB aerial integrated in the right rearview mirror
- Steering wheel with radio control
- Passengers airbag

Pack value 2.663 €

Saving -647 €

Pack price

2.016 €*

DESIGN PACK

+ 0,3 KG

- Steering wheel and gear lever in real leather, Fiat original part
- Dashboard display with chrome-coloured profile, Fiat original part
- Dashboard "Techno" with aluminium frames around warm air vents, Fiat original parts
- Engine grill colour glossy black
- Headlights with black frame design
- LED daytime running lights, Fiat original part

Pack value 1.000 €

Saving -329 €

Pack price

671 €*

SECURITY PACK

+ 1,5 KG

- Driving assistance: full brake control, highbeam/lowbeam, LDWS, signal recognition, rain and light sensor
- TPMS tyre pressure checking system

Pack value 1.092 €

Saving -253 €

Pack price

839 €*

SAFETY PACK

+ 4,2 KG

- Parking sensors, front (4 pieces)
- Parking sensors, rear (4 pieces)
- Antitheft system, volumetric and perimetric, with remote control integrated in the chassis key
- Antitheft window sensors (6 pieces, only possible with anti-theft system)

Pack value 1.680 €

Saving -504 €

Pack price

1.176 €*

- (3) Allows to turn on / off the heating system via Bluetooth or GSM (SIM). The dedicated SIM is not provided by Laika.
- (8) Blind not available for Kosmo 209.

COMFORT PACK

+ 12,5 KG

- Window in bathroom ⁽⁸⁾
- Wooden footboard in shower
- Carpet for driving cab and small carpet for internal step at entrance door
- Insulation for waste water tank

Pack value	744 €
Saving	-408 €

Pack price

335 €*

SMART HOME PACK

+ 9,5 KG

- Gas detector
- Digital board control panel of heating system
- Insulation and heating for waste water tank
- Gas regulator
- Adjustable TV stand in entrance area/above fridge

Pack value	1.344 €
Saving	-252 €

Pack price

1.092 €*

MULTIMEDIA PACK

+ 7,8 KG

- 8" Multimedia System
- DAB radio
- Touchscreen
- Navigation system with 3 year subscription
- Rear camera
- Sound activators

Pack value	1.680€
Saving	-168 €

Pack price

1.512 €*

SUMMER PACK

+ 66,5 KG ²⁰⁰ | + 70,5 KG ⁵⁰⁰

- 2,200 W Air conditioning in living area
- External shower (cold water)
- Awning (manual) 4 m, exterior paint white (Kosmo 200)
/ Awning (manual) 4.5 m, exterior paint white (Kosmo 500)

Kosmo 200 | 500

Pack value	3.024 € 3.192 €
Saving	-672 € -672 €

Pack price

2.352 €* | 2.520 €*

WINTER PACK

(AIR HEATING SYSTEM)

+ 13,0 KG

- Heating Combi 6E
- Floor warming (part of floor)
- Device permitting remote control of the heater via smartphone ⁽³⁾

Pack value **1.344 €**

Saving **-504 €**

Pack price

839 € *

WINTER PACK

(WATER HEATING SYSTEM)

+ 67,0 KG

- Heating system, hot water heating
- Floor warming (part of floor)
- Device permitting remote control of the heater via smartphone ⁽³⁾

Pack value **3.276 €**

Saving **-840 €**

Pack price

2.436 € *

KOSMO LOW-PROFILES

ACCESSORIES

Code No.	Accessories	Price €*	Kg	209	509	509L	512
CHASSIS AND CAB							
1LR	16" Alloy wheels Fiat original parts, Heavy chassis (4 pieces)	300 €	0,0 kg	○	○	○	○
431	16" Alloy wheels Fiat original parts, Light chassis, incl. 16" tyres (4 pieces)	450 €	12,0 kg	○	○	○	○
404	16" Tyres for Fiat Light chassis (total height of the vehicle is increased by 5 cm)	150 €	12,0 kg	○	○	○	○
140	Air conditioning for cab, automatic, Fiat original part (price difference on manual air conditioning)	406 €	0,0 kg	○	○	○	○
AT9-140	Automatic transmission for engine 140 BHP (possible only with Eco Pack cod. 0AA), 16" tyres obligatory (see code 404), 16" tyres obligatory (see code 404)	2.800 €	48,0 kg	○	○	○	○
AT9-160-180	Automatic transmission for engine 160 BHP and 180 BHP, 16" tyres obligatory (see code 404)	2.800 €	33,0 kg	○	○	○	○
2808053	Blinds, internal, sliding, for windshield and cab windows (they replace the standard separation curtain between cab/living area)	450 €	4,5 kg	○	○	○	○
2734600	Chassis Fiat Heavy 4,250 kg	1.210 €	40,0 kg	○	○	○	○
2734602	Chassis Fiat Heavy 4,400 kg (possible only with 160 BHP or 180 BHP)	1.426 €	40,0 kg	○	○	○	○
3065127	Diesel tank 90 l, Fiat chassis	84 €	12,0 kg	○	○	○	○
0AA	Eco Pack Start & Stop function incl. booster (not in conjunction with 120 bhp, 140 bhp optional, 160 bhp and 180 bhp standard)	280 €	2,0 kg	○	○	○	○
5QD	Engine battery cut off switch, Fiat original part	50 €	0,0 kg	○	○	○	○
3057312	Engine Fiat 2.3, 140 BHP, Euro 6d Temp	650 €	0,0 kg	○	○	○	○
3056219	Engine Fiat 2.3, 160 BHP, Euro 6d Temp, including Eco Pack	2.430 €	15,0 kg	○	○	○	○

(*) Prices ex-works quoted without local VAT and without local taxes. Please note the information and explanations on the last page.

S = Standard

O = Option

- technically not possible

(5) With the drop-down bed over the living room, the roof-light 70x50 cm is replaced by the roof-light 40x40 cm.

Code No.	Accessories	Price €* €	Kg	209	509	509L	512
3056223	Engine Fiat 2.3, 180 BHP, Euro 6d Temp, including Eco Pack	3.930 €	15,0 kg	O	O	O	O
FD6	Fifth seat with removable seat	583 €	11,0 kg	-	O	-	-
75P	Fog lights, Fiat original part	243 €	0,6 kg	O	O	O	O
09U	Heated cab seats, original Fiat part (2 pieces)	580 €	1,0 kg	O	O	O	O
2043605	Increased weight 3,650 kg, Fiat Light chassis	217 €	0,0 kg	O	O	O	O
320	Steering wheel and gear lever in real leather, Fiat original part	248 €	0,3 kg	O	O	O	O

INTERIOR ACCESSORIES

2989114	19" TV LED DVD, with decoder and adjustable TV stand, entrance area	756 €	7,5 kg	O	O	O	O
2989118	22" TV LED DVD, with decoder and adjustable TV stand, entrance area	689 €	7,5 kg	O	O	O	O
3171460	32" TV LED DVD, with decoder and adjustable TV stand, entrance area	1.175 €	10,3 kg	O	O	O	O
FD7	Bed in the lounge (single bed) with telescopic table leg	295	10,0 kg	-	O	O	O
F04	Drop-down bed, electric, above the lounge ⁽⁵⁾	1.310 €	40,0 kg	O	O	O	O
F27	Extractor fan	387 €	3,0 kg	O	O	O	O
FO	Gas oven with grill	530 €	17,0 kg	O	O	O	O
FC5	Rear double bed with ladder	259 €	9,0 kg	O	O	O	-
C30	Second battery for living area	263 €	27,0 kg	O	O	O	O
2333651	Table with folding top and telescopic leg (bed in lounge not possible)	238 €	10,0 kg	O	O	O	-
EX	Upholstery Alba	383 €	0,0 kg				
EE	Upholstery Firenze, leatherette	550 €	0,0 kg	O	O	O	O
TT2	Upholstery Udine	550 €	0,0 kg				
KN	Upholstery Vip Club, real leather, made in Italy	2.366 €	4,0 kg	O	O	O	O

EXTERIOR ACCESSORIES

2059419	120 W Solar panel with control and fixing brackets	726 €	15,5 kg	O	O	O	O
D11	Awning (manual) 4 m, exterior paint white	818 €	30,0 kg	O	O	O	O
C49	Awning (manual) 4.5 m, exterior paint white	962 €	34,0 kg	O	O	O	O
37831	Bicycle rack, foldable, with 3 bike rails	330 €	9,3 kg	O	O	O	O
37832	Bike rack fourth holder	77 €	1,0 kg	O	O	O	O
F44	Gas socket, external	193 €	1,0 kg	O	O	O	O
AN3	Satellite aerial 80 HD	1.950 €	17,0 kg	O	O	O	O
F23	Stabilising jacks	251 €	6,0 kg	O	O	O	O
67201	Tow hitch	1.106 €	35,0 kg	O	O	O	O
2971001	Video reversing camera, infrared, with 7" colour screen	616 €	0,5 kg	O	-	-	-