

ECOVIP LOW-PROFILES

STANDARD ECOVIP LOW-PROFILES DATA

| | | |
|---|---------|----------------------|
| Standard chassis | | Fiat Ducato 35 Light |
| Engine displacement | cc | 2.287 |
| Maximum power | kW (hp) | 88 (120) |
| Towable mass ^(H) | kg | 2.000 |
| Fresh water tank capacity (antifreeze) ^(K) | l | 100 + 20 |
| Waste water recovery tank capacity | l | 100 |
| Hot air channeled heating system | kW | 6 |

Model shown: Ecovip L 3019





CHASSIS

- Fiat Ducato mechanics, Turbo Diesel Common Rail, Euro 6d Temp
- White driving cab with bumpers painted in white
- Front wheel drive
- Enlarged rear track
- Electronic Stability Control: ESP specific for campers, ABS, ASR, Hill Holder and Roll Over Mitigation
- Front and rear sway bar
- 6-speed + 1 manual gearbox
- Drivers airbag
- 60 l diesel tank
- Electrical power windows in cab
- Day lights built into headlights
- Headlight levellers
- Cup holder in cab
- 12 V and USB outlet in cab (max 180 W)
- Height adjustable driver's cab seat
- Swivel cab seating with headrest, two armrests, inclining backrest
- Ergonomic, very comfortable cab seating with upholstery coordinated with living room
- Adjustable height steering wheel

DESIGN & BODYWORK

- Polyurethane wall and roof framework
- Walls, roof and floor highly insulated with extruded polystyrene foam (XPS)
- Aluminium external walls, anti-yellowing
- Roof lined in hail protection fibreglass
- Fibreglass sub-floor
- Hot-dip galvanised counter-frame
- Heated and illuminated double floor, with heat storage function, accessible from outside and inside the vehicle, technical systems and storage compartments
- Floor hatches for internal access to the systems and storage compartments in the double floor
- Monobloc fibreglass front windshield and high insulation and heated cell/cabin connection
- Rear wall with automotive design and LED light clusters and dynamic indicators
- High quality frame windows with silver polyurethane frame, flat window pane,

- blind and mosquito net
- External design graphics
- Premium XL airframe door with central locking and remote control, two closure points, window, blind, glove box and sliding insect screen
- Large electric step combined with an integrated step for maximum climbing comfort
- External LED light
- Centralised cab and living space door closure with remote control
- Single door key
- Rear, large heated, insulated and lit garage and locker, with double latching locks and centralised control
- Washable garage floor with water drain and central reinforcement in almond-coloured aluminium
- Garage capacity 250 kg
- Garage door open dashboard warning light
- Gas cylinder compartment in lowered position and with oversized door for easy access

KITCHEN & BATHROOM

- Trivalent refrigerator with automatic energy source selection (AES), with smoky (or anthracite) covering and external inspection grille
- Scratch and fingerprint resistant kitchen and table tops
- Indirect lighting under kitchen top
- Multi-purpose sink cover cutting board
- Kitchen window design panel in metallic silver with brushed effect
- 3-burner stove
- Double chrome-plated stainless steel sink (Ecovip L 3010, 3019, 4009, 4012)
- Automatic soft-close drawers
- Extractor hood with external vent
- 230 V outlet in kitchen
- 40x40 cm roof-light in kitchen
- High quality metal kitchen and bathroom mixer
- Elegant design bathroom
- Extra high shower and towel rack
- Possibility of bathroom window (opt)
- Waste water tank (antifreeze) with 18 l cassette

SYSTEMS

- Ducted heating with heating unit in central position, capillary heat distribution with elements also inserted in the double floor, in the driver's cabin and in the rear garage
- Possibility of liquid circulation heating with convectors positioned in every room, including the driver's cab, and heat exchanger in motion (opt)
- Protected systems inside the double floor
- Anti-freeze water system with internal ducts, oversized pipes and routes combined with hot air ducting
- Insulated and heated grey water tank, complete with external vent and anti-odour siphons
- Drinking water tank and recovery tank with access from the double floor
- Pressure water pump with expansion tank in protected and heated room accessible from the rear garage
- Two USB outlets in the rear bedroom and one USB outlet in the living area
- Control panel electrical system of the latest generation complete with colour LCD screen and programmable functions
- Automatic 20 A battery charger

EQUIPMENT

INTERIOR & COMFORT

- High-quality, multi-level, fully LED lighting system with multi-way and dimmer controls, with direct and indirect light sources covering every area of the passenger compartment, including entrance step, wardrobe cabinet, wall units, rear garage and double floor
- Steps night lights
- Insulated/upholstered ceiling with elegant Laika-Iso-Deluxe material
- Single living area level flooring without stairs to rear bedroom
- Two different furniture styles
- Interior design (standard):
- Rovere Moka ^(a)
- Interior design (option): Pero Toscano ^(a)
- Bari upholstery with stain protection treatment
- Wall units with oversized doors with ergonomic chrome-plated metal handles, exclusive Laika and integrated indirect light
- White wall unit doors with ergonomic chrome handles
- Ergonomic "L" shaped living room with modular domestic type cushions and high comfort padding (except DS versions)
- Face-To-Face living room with opposite benches with high comfort modular domestic cushions and a system for transforming the sofas into two additional front seats complete with headrest and 3-point safety belts
- Living room cushions with removable covers and modular style at will for individual tasteful atmospheres
- Extremely comfortable table, with chrome leg, movable in all directions with easy handling, 360° adjustable
- 70x50 cm roof-light in living area (b)
- Panoramic roof-light, opening, over the driving cab and integrated in the overcabin
- TV compartment in living room for LCD/LED screens up to 32"
- Electrical drop-down bed (opt) with reading spot and USB sockets, high quality mattress, slatted frame and safety anti-fall net
- Heated driver's cab with central system branches
- Wardrobe with pull-out hanger for maximum convenience (Ecovip L 3009/3019/4009/4009DS)
- TV viewable even from the folding bed
- Shoe compartment at living space entry
- Sliding rear bedroom separation door (Ecovip L 3412 DS, 4009 DS, 4009 DS, 4012 DS)
- Possibility of using the hinged toilet door to separate the rear of the passenger compartment (except on Ecovip L 2009)
- Adjustable reading lights and USB sockets on all beds
- Back Ergonomy high comfort, anti-mite, breathable mattresses with machine washable stretch lining
- Beds with wooden staves
- Adjustable reading lights on all beds
- Extensive customisation possibilities

STANDARD SETTINGS FOR:

- Tow hitch
- Internal wall unit-roof-power supply wiring passage
- Additional waste water tank with level reading
- Reversing camera
- Rear parking sensors
- Electric ventilator for porthole in bathroom and kitchen
- TV in living area
- TV in back room
- Radio

(a) = Rovere Moka interior design and Pero Toscano interior design differences: wood design, floor design, interior walls of the vehicle.

(b) = With foldaway bed over living area, the 50x70 cm roof-light will be replaced with a 40x40 cm roof-light.



OVERVIEW OF ALL MODELS

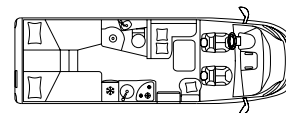
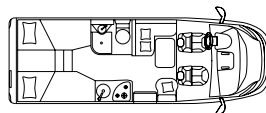

MODELS

ECOVIP L 2009

ECOVIP L 3009

| | | | |
|---|----|--|---|
| External length / width / height ^(D, E) | cm | 659 / 225 / 296 | 699 / 225 / 296 |
| Internal width / height | cm | 212 / 205 | 212 / 205 |
| Wheelbase | mm | 3.450 | 3.800 |
| Weight in running order ^(J) | kg | n.a. | 2.928 |
| Payload (approx.) ^(F) | kg | n.a. | 572 ^S / 722 ^O |
| Maximum total weight | kg | 3.500 ^S / 3.650 ^O | 3.500 ^S / 3.650 ^O |
| Type-approved seats ^(B) | | 4 ^S + 5 ^O | 4 ^S + 5 ^O |
| Wall / roof / floor (thickness) | mm | 34 / 38 / 52 | 34 / 38 / 52 |
| Double floor height (max / min) | mm | 300 - 160 | 300 - 160 |
| Garage dimensions (W x H x L) | cm | nd | 212 x 124 x 121 ^{max} / 102 ^{min} |
| Right hatch / left hatch (W x H) | cm | 95 x 115 / 51 x 80 | 95 x 115 / 51 x 80 |
| Berths | | 2 ^S + 1 ^O + 1 ^O | 2 ^S + 1 ^O + 1 ^O |
| Right side rear bed / left side rear bed (with slats) | cm | 197 x 82 / 185 x 82 | 197 x 82 / 197 x 82 |
| Double rear bed with slats | cm | O | O |
| Rear bed electrically adjustable height | | - | - |
| Dinette bed | cm | 188 x 90 / 45 ^O | 188 x 110 / 45 ^O |
| Electric-powered drop-down bed above the living room ^{O (L)} | cm | n.a. | 186 x 121 / 100 |
| Separation door living/night area | | - | S |
| Refrigerator with automatic source selection and external inspection grid | l | 106 | 140 |
| Transparent roof-light in bathroom | cm | 28 x 28 | 28 x 28 |
| 12 V sockets / 230 V sockets / USB socket | | 2 / 4 / (1+2) | 2 / 5 / (1+2) |
| TV sockets in living room - rear bedroom | | 1 / 1 | 1 / 1 |

OPTIONAL

| | | | |
|--|---------|---|---|
| Optional Chassis | | Fiat Ducato 43 Heavy | Fiat Ducato 43 Heavy |
| Maximum power | kW (hp) | 103 (140), 117 (160), 130 (180) | 103 (140), 117 (160), 130 (180) |
| Weight in running order ^(J) | kg | n.a. | 2.968 |
| Payload (approx.) ^(F) | kg | n.a. | 1.282 ^S / 1.432 ^O |
| Maximum total weight ^(C) | kg | 4.250 ^S / 4.400 ^O | 4.250 ^S / 4.400 ^O |

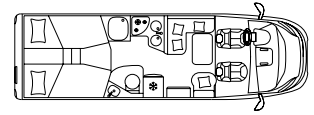
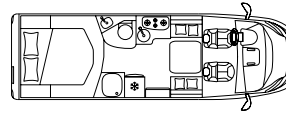
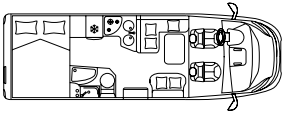
**ECOVIP L 3010****ECOVIP L 3019****ECOVIP L 3412 DS****ECOVIP L 4009**

| | | | |
|--|--|---|--|
| 699 / 225 / 296 | 699 / 225 / 296 | 720 / 225 / 296 | 740 / 225 / 296 |
| 212 / 205 | 212 / 205 | 212 / 205 | 212 / 205 |
| 4.035 | 3.800 | 4.035 | 4.035 |
| n.a. | 2.953 | n.a. | n.a. |
| n.a. | 547 ^S / 697 ^O | n.a. | n.a. |
| 3.500 ^S / 3.650 ^O | 3.500 ^S / 3.650 ^O | 3.500 ^S / 3.650 ^O | 3.500 ^S / 3.650 ^O |
| 4 ^S + 5 ^O | 4 ^S + 5 ^O | 4 ^S | 4 ^S + 5 ^O |
| 34 / 38 / 52 | 34 / 38 / 52 | 34 / 38 / 52 | 34 / 38 / 52 |
| 300 - 160 | 300 - 160 | 300 - 160 | 300 ^{max} / 160 ^{min} |
| nd | 212 × 124 × 121 ^{max} / 97 ^{min} | 212 × 123 × 136 ^{max} / 123 ^{min} | 212 × 124 × 121 ^{max} / 95 ^{min} |
| 85 × 115 / 51 × 80 | 95 × 115 / 51 × 80 | 95 × 115 / 51 × 80 | 95 × 115 / 51 × 80 |
| 2 ^S + 2 ^O + 1 ^O | 2 ^S + 2 ^O + 1 ^O | 2 ^S + 2 ^O + 1 ^O | 2 ^S + 2 ^O + 1 ^O |
| - / - | 193 × 82 / 191 × 82 | - / - | 206 × 82 / 206 × 82 |
| 205 × 140 | O | 190 × 150 | 190 × 150 |
| - | - | O | - |
| 188 × 110 / 58 ^O | 188 × 100 / 58 ^O | 183 × 70 ^O | 188 × 110 / 58 ^O |
| 186 × 139 / 109 | 186 × 139 / 109 | 186 × 139 | 186 × 139 / 112 |
| S | S | S | S |
| 140 | 140 | 140 | 153 |
| 28 × 28 | 28 × 28 | 28 × 28 | 28 × 28 |
| 2 / 4 / (1+2) | 2 / 4 / (1+2) | 2 / 4 / (1+2) | 2 / 4 / (1+2) |
| 1 / 1 | 1 / 1 | 1 / 1 | 1 / 1 |
| Fiat Ducato 43 Heavy | Fiat Ducato 43 Heavy | Fiat Ducato 43 Heavy | Fiat Ducato 43 Heavy |
| 103 (140), 117 (160), 130 (180) | 103 (140), 117 (160), 130 (180) | 103 (140), 117 (160), 130 (180) | 103 (140), 117 (160), 130 (180) |
| n.a. | 2.993 | n.a. | n.a. |
| n.a. | 1.257 ^S / 1.407 ^O | n.a. | n.a. |
| 4.250 ^S / 4.400 ^O | 4.250 ^S / 4.400 ^O | 4.250 ^S / 4.400 ^O | 4.250 ^S / 4.400 ^O |

OVERVIEW OF ALL MODELS

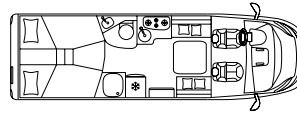

MODELS

ECOVIP L 4009 DS

ECOVIP L 4012

| | | | |
|---|----|--|---|
| External length / width / height ^(D, E) | cm | 740 / 225 / 296 | 740 / 225 / 296 |
| Internal width / height | cm | 212 / 205 | 212 / 205 |
| Wheelbase | mm | 4,035 | 4,035 |
| Weight in running order ^(J) | kg | n.a. | n.a. |
| Payload (approx.) ^(F) | kg | n.a. | n.a. |
| Maximum total weight | kg | 3.500 ^S / 3.650 ^O | 3.500 ^S / 3.650 ^O |
| Type-approved seats ^(B) | | 4 ^S + 5 ^O | 4 ^S + 5 ^O |
| Wall / roof / floor (thickness) | mm | 34 / 38 / 52 | 34 / 38 / 52 |
| Double floor height (max / min) | mm | 300 - 160 | 300 - 160 |
| Garage dimensions (W x H x L) | cm | 212 x 124 x 121 ^{max} / 95 ^{min} | 212 x 123 x 136 ^{max} / 123 ^{min} |
| Right hatch / left hatch (W x H) | cm | 95 x 115 / 51 x 80 | 95 x 115 / 51 x 80 |
| Berths | | 2 ^S + 2 ^O + 1 ^O | 2 ^S + 2 ^O + 1 ^O |
| Right side rear bed / left side rear bed (with slats) | cm | 202 x 82 / 206 x 82 | - / - |
| Double rear bed with slats | cm | 190 x 150 | 190 x 150 |
| Rear bed electrically adjustable height | | - | O |
| Dinette bed | cm | 183 x 80 ^O | 188 x 110 / 58 ^O |
| Electric-powered drop-down bed above the living room ^{O (L)} | cm | 186 x 139 | 186 x 139 / 112 |
| Separation door living/night area | | S | S |
| Refrigerator with automatic source selection and external inspection grid | l | 153 | 153 |
| Transparent roof-light in bathroom | cm | 28 x 28 | 28 x 28 |
| 12 V sockets / 230 V sockets / USB socket | | 2 / 4 / (1+2) | 2 / 4 / (1+2) |
| TV sockets in living room - rear bedroom | | 1 / 1 | 1 / 1 |

OPTIONAL

| | | | |
|--|---------|---|---|
| Optional Chassis | | Fiat Ducato 43 Heavy | Fiat Ducato 43 Heavy |
| Maximum power | kW (Hp) | 103 (140), 117 (160), 130 (180) | 103 (140), 117 (160), 130 (180) |
| Weight in running order ^(J) | kg | n.a. | n.a. |
| Payload (approx.) ^(F) | kg | n.a. | n.a. |
| Maximum total weight ^(C) | kg | 4.250 ^S / 4.400 ^O | 4.250 ^S / 4.400 ^O |

PACKS

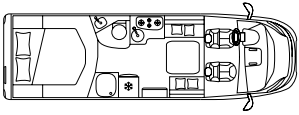

ECOVIP L 4012 DS

| |
|---|
| 740 / 225 / 296 |
| 212 / 205 |
| 4,035 |
| n.a. |
| n.a. |
| 3.500 ^s / 3.650 ^o |
| 4 ^s |
| 34 / 38 / 52 |
| 300 - 160 |
| 212 × 123 × 136 ^{max} / 123 ^{min} |
| 95 × 115 / 51 × 80 |
| 2 ^s + 2 ^o + 1 ^o |
| - / - |
| 190 × 150 |
| O |
| 183 × 80 ^o |
| 186 × 139 |
| S |
| 153 |
| 28 × 28 |
| 2 / 4 / (1+2) |
| 1 / 1 |
| Fiat Ducato 43 Heavy |
| 103 (140), 117 (160), 130 (180) |
| n.a. |
| n.a. |
| 4.250 ^s / 4.400 ^o |

CHASSIS PACK

+ 40,9 KG ^{LIGHT} | + 30,9 KG ^{HEAVY}

- Traction+, Hill Descent
- Electric and heated rearview mirrors
- Cruise control
- Provision for DAB radio aerial and cab loudspeakers
- DAB aerial on right rearview mirror, Fiat original part
- Height adjustable passengers cab seat, Fiat original part
- Eco Pack: Start&Stop, intelligent alternator control, electronically controlled fuel pump
- 16" Alloy wheels Fiat original parts, Light chassis / Alloy wheels, 16" Fiat original parts, Heavy chassis
- Manual single-zone air conditioning for cab, Fiat original part
- Steering wheel radio control
- Passengers airbag

Not possible with 120 HP.

Pack value 3.613 €

Saving -924 €

Pack price

2.688 €*

COMFORT PACK

+ 20,1 KG

- Window in bathroom
- Shower with wooden footboard
- Carpet for driving cab and small carpet for internal step at entrance door
- Waste water electric valve drainage
- Preparation for rear camera
- Dimmable lights
- Blind, internal and sliding
- Device permitting remote control of the heater via smartphone ⁽³⁾
- Digital board control panel of heating system

Pack value 1.344 €

Saving -504 €

Pack price

839 €*

PACKS

CHASSIS PACK AUTOMATIC

+ 40,9 KG ^{LIGHT} | + 30,9 KG ^{HEAVY}

- Traction+, Hill Descent
- Electric and heated rearview mirrors
- Cruise control
- Provision for DAB radio aerial and cab loudspeakers
- DAB aerial on right rearview mirror, Fiat original part
- Height adjustable passengers cab seat, Fiat original part
- Eco Pack: Start&Stop, intelligent alternator control, electronically controlled fuel pump
- 16" Alloy wheels Fiat original parts, Light chassis / Alloy wheels, 16" Fiat original parts, Heavy chassis
- Automatic air conditioning for cab, Fiat original part
- Steering wheel radio control
- Passengers airbag

| | |
|-------------------|----------------|
| Pack value | 3.949 € |
| Saving | -924 € |

Pack price **3.024 €***

SECURITY PACK

+ 1,5 KG

- Driving assistance: full brake control, highbeam/lowbeam, LDWS, signal recognition, rain and light sensor
- TPMS tyre pressure checking system

| | |
|-------------------|----------------|
| Pack value | 1.092 € |
| Saving | -261 € |

Pack price **832 €***

DESIGN PACK

+ 0,3 KG

- Steering wheel and gear lever in real leather, Fiat original part
- Dashboard display with chrome-coloured profile, Fiat original part
- Dashboard "Techno" with aluminium frames around warm air vents, Fiat original parts
- Engine grill colour glossy black
- Headlights with black frame design
- LED daytime running lights, Fiat original part

| | |
|-------------------|----------------|
| Pack value | 1.088 € |
| Saving | -336 € |

Pack price **671 €***

DESIGN PACK SILVER

+ 0,3 KG

- Steering wheel and gear lever in real leather, Fiat original part
- Dashboard display with chrome-coloured profile, Fiat original part
- Dashboard "Techno" with aluminium frames around warm air vents, Fiat original parts
- Engine grill colour glossy black
- Headlights with black frame design
- LED daytime running lights, Fiat original part
- Cab body and front bumper in silver colour

| | |
|-------------------|----------------|
| Pack value | 1.260 € |
| Saving | -420 € |

Pack price **839 €***

SAFETY PACK

+ 4,2 KG

- Parking sensors, front (4 pieces)
- Parking sensors, rear (4 pieces)
- Antitheft system, volumetric and perimetric, with remote control integrated in the chassis key
- Antitheft window sensors (6 pieces, only possible with anti-theft system)

Pack value 1.672 €

Saving -497 €

Pack price

1.176 €*

SMART HOME PACK

+ 5,8 KG

- Gas detector
- Gas regulator with antifreeze device and remote control

Pack value 671 €

Saving -252€

Pack price

419 €*

MULTIMEDIA PACK

+ 7,8 KG

- 9" Multimedia System
- DAB radio
- Touchscreen
- Navigation system and 3 year subscription
- Loudspeakers
- Rear camera

Pack value 1.680 €

Saving -168 €

Pack price

1.512 €*

SUMMER PACK

+ 69,5 KG ^{3,7M} | + 72,5 KG ^{4M} | + 77,5 KG ^{4,5M}

- 2,200 W Air conditioning living area
- External Shower (hot/cold water)
- Awning 3,7 m (Ecovip L 2009)
- Awning 4 m (Ecovip L 3009, L 3010, L 3019, L 3412 DS)
- Awning 4,5 m (Ecovip L 4009, L 4009 DS, L 4012, L 4012 DS)

Pack value 4.201 €

Saving -924 €

Pack price

3.276 €*

ACCESSORIES

Code No. Accessories Price €* Kg L 2009

CHASSIS AND CAB

| | | | | |
|-------------|--|---------|---------|---|
| 906 | Additional heating system for living area | 210 € | 3,5 kg | O |
| AT9-140 | Automatic gearbox Heavy - 140 BHP (possible only with Eco Pack cod, 0AA) | 2.800 € | 18,0 kg | O |
| AT9-160-180 | Automatic gearbox Heavy - 160 BHP and 180 BHP | 2.800 € | 3,0 kg | O |
| 2JH-1 | Automatic transmission 140 BHP (incl. alloy wheels, possible only with Eco Pack cod, 0AA) | 2.800 € | 58,0 kg | O |
| 2JH-2 | Automatic transmission 160 BHP and 180 BHP (incl. alloy wheels) | 2.800 € | 43,0 kg | O |
| 09U | Cab seats with seat heating, original Fiat part (2 pieces) | 580 € | 1,0 kg | O |
| 2734600 | Chassis Fiat Heavy 4,250 kg | 1.210 € | 40,0 kg | O |
| 2734602 | Chassis Fiat Heavy 4,400 kg (possible only with 160 BHP or 180 BHP) | 1.426 € | 40,0 kg | O |
| 205 | Diesel heating, Fiat original part | 950 € | 6,0 kg | O |
| 3065128 | Diesel tank 90 l, Fiat chassis | 84 € | 27,0 kg | O |
| 0AA | Eco Pack Start & Stop function incl. booster (not in conjunction with 120 bhp, 140 bhp optional, 160 bhp and 180 bhp standard) | 280 € | 2,0 kg | O |
| 5QD | Engine battery cut off switch, Fiat original part | 50 € | 0,0 kg | O |
| 3057312 | Engine Fiat 2.3, 140 BHP, Euro 6d Temp | 650 € | 0,0 kg | O |
| 3056219 | Engine Fiat 2.3, 160 BHP, Euro 6d Temp, including Eco Pack | 2.430 € | 15,0 kg | O |
| 3056223 | Engine Fiat 2.3, 180 BHP, Euro 6d Temp, including Eco Pack | 3.930 € | 15,0 kg | O |
| 2281023 | Fifth seat with removable seat (please check if possible without weight increase) | 583 € | 8,0 kg | O |
| 75P | Fog lights, Fiat original part | 243 € | 0,6 kg | O |
| 2043605 | Increased weight 3,650 kg, Fiat Light chassis | 217 € | 0,0 kg | O |
| 2013861 | Laika logo stickers for Fiat wheel covers or alloy wheels (4 pieces) | 32 € | 0,1 kg | O |
| 52X | Provision for gasoline heating on Fiat chassis | 84 € | 3,5 kg | O |

INTERIOR ACCESSORIES

| | | | | |
|----------------------|--|---------|---------|---|
| 146 | 32" TV LED DVD, with decoder and adjustable TV stand | 1.175 € | 7,0 kg | - |
| FD1 | Adjustable TV stand | 137 € | 3,0 kg | - |
| FL4 | Battery charger, additional, 20 A | 218 € | 1,0 kg | O |
| 2843590 | Bed in the lounge (single bed) with telescopic table leg | 295 € | 10,0 kg | - |
| 2888573 / 2888574 | Carpet for living area | 588 € | 7,5 kg | - |
| T07 | Cushions Lazio | 336 € | 0,0 kg | O |
| T04 | Cushions Liguria | 336 € | 0,0 kg | O |
| T02 | Cushions Sardegna | 336 € | 0,0 kg | O |
| T01 | Cushions Sicilia | 336 € | 0,0 kg | O |
| T03 | Cushions Umbria | 378 € | 0,0 kg | O |

ACCESSORIES

Code No. Accessories Price €* Kg L 2009

INTERIOR ACCESSORIES

| | | | | |
|---------|---|---------|---------|---|
| T05 | Cushions Veneto | 378 € | 0,0 kg | O |
| T08 | Cushions Vip Club | 588 € | 0,0 kg | O |
| D42 | Diesel heating, 6 KW, Fiat Ducato (possible only with 52X) | 554 € | 1,0 kg | O |
| F04 | Drop-down bed, electric, above the lounge ⁽⁵⁾ | 1.310 € | 40,0 kg | O |
| X8 | Furniture design Pero Toscano | 0 € | 0,0 kg | O |
| F07 | Gas oven with grill | 387 € | 20,0 kg | O |
| F44 | Gas socket, external | 193 € | 1,0 kg | - |
| FH6 | Heating Diesel / electric (possible only with 52X) | 807 € | 5,0 kg | O |
| 53608 | Heating, additional diesel heating | 1.998 € | 17,5 kg | O |
| 2471995 | Heating Combi 6E | 435 € | 3,0 kg | O |
| ALD | Heating system, hot water heating | 2.230 € | 57,0 kg | O |
| 63815 | Kitchen "Grand Chef" version, 3 burners and integrated gas oven with grill ⁽⁴⁾ | 731 € | 5,0 kg | - |
| 60424 | Preparation for a second living area battery | 87 € | 0,5 kg | O |
| FL5 | Preparation for a second living area battery | 0 € | 0,5 kg | O |
| 3105529 | Rear double bed, electrically adjustable in height | 1.270 € | 25,0 kg | - |
| FC5 | Rear double bed with ladder | 259 € | 5,0 kg | O |
| C30 | Second battery for living area | 263 € | 27,0 kg | O |
| 2333651 | Table with folding top and telescopic leg (bed in lounge not possible) | 238 € | 10,0 kg | O |
| TT2 | Upholstery Udine | 550 € | 0,0 kg | O |
| KN | Upholstery Vip Club, real leather, made in Italy | 2.366 € | 4,0 kg | O |

EXTERIOR ACCESSORIES

| | | | | |
|---------|---|---------|---------|---|
| 2059419 | 120 W Solar panel with control and fixing brackets | 726 € | 15,5 kg | O |
| FL6 | 120 W Solar panel with control and fixing brackets | 726 € | 15,5 kg | O |
| 3242620 | Awning Laika, 3,7 m, white housing | 839 € | 33,5 kg | O |
| 3231890 | Awning Laika, 4 m, white housing | 900 € | 36,5 kg | - |
| 2065671 | Awning Laika, 4,5 m, white housing | 1.075 € | 41,5 kg | - |
| | Additional fresh water tank 67 l, to be used in summer time | 590 € | 15,0 kg | O |
| 2054611 | Additional remote control for alarm | 178 € | 0,2 kg | O |
| 37831 | Bicycle rack, foldable, with 3 bike rails | 330 € | 9,3 kg | O |
| 3076983 | Gas regulator with antifreeze device and remote control | 287 € | 1,5 kg | O |
| 2059062 | Roof-light with electric ventilator, kitchen, white cover | 128 € | 2,0 kg | O |
| 2390009 | Roof-light with electric ventilator, shower, white cover | 128 € | 2,0 kg | O |
| 2813182 | Satellite aerial (GDX, E, B) | 1.571 € | 17,0 kg | O |
| AN3 | Satellite aerial 80 HD | 1.950 € | 17,0 kg | O |
| 54105 | Stabilising jacks with warning light (2 pieces) | 424 € | 11,0 kg | - |
| 3242620 | Tow hitch | 1.390 € | 66,0 kg | O |

(*) Prices ex-works quoted without local VAT and without local taxes. Please note the information and explanations on the last page.

S = Standard

O = Option

- technically not possible

(5) With the drop-down bed over the living room, the roof-light 70x50 cm is replaced by the roof-light 40x40 cm.

| L 3009 | L 3010 | L 3019 | L 3412 DS | L 4009 | L 4009 DS | L 4012 | L 4012 DS |
|--------|--------|--------|-----------|--------|-----------|--------|-----------|
| O | O | O | O | O | O | O | O |
| O | O | O | O | O | O | O | O |
| O | O | - | - | - | O | - | O |
| O | O | O | O | O | O | O | O |
| O | O | O | O | O | O | O | O |
| O | O | O | O | O | O | O | O |
| O | O | O | O | O | O | O | O |
| - | - | O | O | O | - | O | - |
| O | O | O | O | O | O | O | O |
| O | O | O | - | O | O | O | O |
| O | O | O | O | O | O | O | O |
| O | O | O | O | O | O | O | O |
| O | O | O | O | O | O | O | O |
| - | O | O | O | O | O | O | O |
| O | O | O | - | O | O | O | O |
| O | O | O | O | O | O | O | O |
| - | - | - | O | - | - | O | O |
| O | O | O | - | O | O | - | O |
| O | O | - | - | - | O | - | O |
| O | O | O | O | O | O | O | O |
| O | O | O | O | O | O | O | O |
| O | O | O | O | O | O | O | O |
| O | O | O | O | O | O | O | O |
| O | O | O | O | O | O | O | O |
| O | O | O | O | O | O | O | O |
| O | O | O | O | O | O | O | O |
| O | O | O | O | O | O | O | O |
| O | O | O | O | O | O | O | O |
| O | O | O | O | O | O | O | O |
| O | O | O | O | O | O | O | O |
| O | O | O | O | O | O | O | O |
| O | O | O | O | O | O | O | O |
| O | O | O | O | O | O | O | O |
| O | O | O | O | O | O | O | O |
| O | O | O | O | O | O | O | O |
| O | O | O | O | O | O | O | O |
| O | O | O | O | O | O | O | O |
| O | O | O | O | O | O | O | O |
| O | O | O | O | O | O | O | O |
| - | - | O | - | O | - | O | - |
| O | O | O | O | O | O | O | O |