

# KOSMO EMBLEMA LOW-PROFILES



## STANDARD KOSMO EMBLEMA LOW-PROFILES DATA

Standard chassis		Fiat Ducato 35 Light
Engine displacement	cc	2.287
Maximum power	kW (hp)	103 (140)
Towable mass <sup>(H)</sup>	kg	2,000
Fresh water tank capacity (antifreeze) <sup>(K)</sup>	l	90 + 20
Waste water recovery tank capacity	l	90
Hot air channeled heating system	kW	6

Model shown: Kosmo Emblema 512 E



# EQUIPMENT



## CHASSIS

- Fiat Ducato mechanics, Turbo Diesel Common Rail, Euro 6d Temp
- Engine Fiat 2,3 L 140 HP
- Driving cab and bumpers painted in same colour
- Front wheel drive
- 16" Alloy wheels
- Enlarged rear track
- Electronic Stability Control: ESP specific for campers, ABS, ASR, Hill Holder and Roll Over Mitigation
- Front and rear sway bar
- 6-speed + 1 manual gearbox
- Driver airbag
- Diesel tank 75 l
- Electrical power windows in cab
- Day lights built into headlights and levellers
- 12 V and USB outlet in cab (max 180 W)
- Swivel cab seating with armrests, seatbelts, adjustable in height (only driver's cab seat), backrest and fabric coordinated with living room
- Adjustable height steering wheel
- Blinds, sliding in driver's cabin
- Carpet for driving cab
- Multimedia system with 2Din radio, speakers in driver's cabin and living room, satellite navigation system, rear view camera

## DESIGN & BODYWORK

- Walls and roof highly insulated with EPS polystyrene foam, roof lined in hail protection fibreglass, aluminium external walls, anti-yellowing
- Fibreglass sub-floor for maximum resistance to gravel and weathering over time
- Automotive headlights, rear side skirts consisting of more pieces to make repair works easier
- High quality, flat frame windows with aluminium frame, blind and mosquito net
- Premium XL living space door with centralised closure, remote control, window, blind, storage compartment and sliding mosquito net
- Aluminium underbody skirts
- External LED light

- Emblema customised exterior graphics
- Centralised door closure with remote control
- Garage with 150 kg payload capacity, low floor with non-slip coating, lighting, heating, rails with load hooks that can be repositioned as required, power socket, double external and internal access door
- 1 piece front windshield in fibreglass with maxi roof-light integrated

## KITCHEN & BATHROOM

- Trivalent 140 l refrigerator with automatic energy source selection (AES)
- Scratch and fingerprint resistant kitchen and table tops
- Kitchen window design panel combined with the worktop
- Dark glass protection panels for kitchen walls
- High gloss white kitchen furniture with storage space and internal shelves with anti-fall edge
- Chromed sink in stainless steel sink with sink cover including chopping board that can also be used as an additional wall shelf (depending on the version)
- Indirect lighting under kitchen top
- 3-burner stove in stainless steel with tempered glass lid
- Automatic soft-close drawers
- Chrome metal spice rack shelf
- 230 V outlet in kitchen
- 40 x 40 cm roof-light in kitchen
- Extractor hood in kitchen (not possible on Emblema 509 LE and 512 E in combination with drop-down bed)
- Toilet with swivel cup and removable cassette 18 litres (frost-resistant)
- Bathroom door also to be used as a separation for the centre of the passenger compartment (Emblema 509 E, 509 LE, 512 E)
- Multifunctional toilet with thermoformed furniture for easy cleaning (Emblema 209 E)
- Separable shower enclosure easily obtainable thanks to the rotation of the washbasin wall. Single lever mixer, bottom plate with waste (Emblema 209 E)
- Shower platform, nautic style

- Toilet with window, blind and mosquito net <sup>(8)</sup>

## SYSTEMS

- 100% LED lighting
- Large floor storage compartment (Emblema 509 E, 509 LE, 512 E)
- Heating 6kW and boiler with heat distribution and ducting throughout the interior, including rear garage and driver's cabin, programmable digital control panel
- Two USB outlets in the rear bedroom and one USB outlet in the living area
- Area for recharging mobile phones and tablets at the entrance: extra compartment, double USB socket
- Electrical system with automatic battery charger 18 A, maintenance-free high-performance service battery 95 A, on-board control panel with LED display
- Gas compartment for two 10 kg cylinders, steel gas pipes, safety isolating valves
- Internal potable water tank, 110 l capacity, easily accessible for cleaning and inspection, high-capacity electric immersion water pump
- Exhaust pipes with anti-odour siphons, recovery tank complete with external vent
- Insulated and heated waste water tank

## INTERIOR & COMFORT

- Entrance area with large integrated step and courtesy handle
- Multi-level indirect lighting in driving cab and lounge
- Internal height up to 213 cm
- Furniture design Noce Italiano
- Noto upholstery and boat style curtains
- Hanging doors in glossy white design, metal handles and high quality mechanical components
- Living room with upholstery and home comforts, adjustable headrests and cushions with removable lining
- Face-to-face living for Emblema 509 LE and 512 E

# EQUIPMENT

- Anti-condensation walls and ventilation in the furniture for an ideal spread of the heat generated by the heating system
- Ergonomic table with moving top and easy handling. Folding table top for Emblema 509 LE and 512 E
- 70x50 cm roof-light in living area (b)
- Maxi panoramic roof-light in the front windshield
- Shoe compartment at living space entry (Emblema 509 E)
- Nautical centre rear bed with manual height adjustment
- Rear beds with wooden staves, high quality, breathable mattresses with machine washable stretch lining
- Customised rear headboard complete with indirect LED lighting
- Panels and padded storage pockets dedicated to the sleeping area
- Adjustable reading lights on rear beds
- Roof-light with transparent dome above

- rear bedroom
- Padded rear headboard
- Rear bedroom separated by courtesy curtain (Emblema 209 E, 509 E)
- Rear bedroom separated by sliding door (Emblema 509 LE, 512 E)
- Storage compartments and indirect lighting inside the overcabin

## STANDARD SETTINGS FOR:

- Tow hitch
- Reversing camera
- TV in living area
- Satellite aerial

(b) = With foldaway bed over living area, the 50x70 cm roof-light will be replaced with a 40x40 cm roof-light.



# OVERVIEW OF ALL MODELS

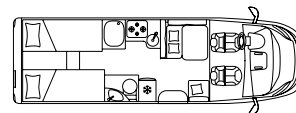
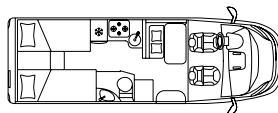

## MODELS

### 209 E

### 509 E

External length / width / height <sup>(D, E)</sup>	cm	695 / 233 / 290	741 / 233 / 294
Internal width / height	cm	218 / 213	218 / 213
Wheelbase	mm	3.800	4.035
Weight in running order <sup>(J)</sup>	kg	2.878	2.993
Payload (approx.) <sup>(F)</sup>	kg	622 <sup>S</sup> / 772 <sup>O</sup>	507 <sup>S</sup> / 657 <sup>O</sup>
Maximum total weight	kg	3.500 <sup>S</sup> / 3.650 <sup>O</sup>	3.500 <sup>S</sup> / 3.650 <sup>O</sup>
Type-approved seats <sup>(B)</sup>		4 <sup>S</sup>	4 <sup>S</sup> / 5 <sup>O</sup>
Wall / roof / floor (thickness)	mm	34 / 33 / 49	34 / 33 / 49
Garage dimensions (W x H x L)	cm	218 x 120 x 91	218 x 121 x 109
Right hatch / left hatch (W x H)	cm	75 x 115 / 75 x 115	93 x 115 / 93 x 115
Berths		2 <sup>S</sup> + 2 <sup>O</sup>	2 <sup>S</sup> + 2 <sup>O</sup> + 1 <sup>O</sup>
Right side rear bed / left side rear bed	cm	201 x 80 / 186 x 80	207 x 80 / 200 x 80
Rear double bed	cm	O	O
Manually height-adjustable double rear bed with wooden staves	cm	-	-
Dinette bed	cm	-	200 x 115 <sup>O</sup>
Electric-powered drop-down bed above the living room <sup>O (L)</sup>	cm	200 x 140	200 x 140
Rear double bed with wooden staves	cm	-	-
Manually height-adjustable double rear bed with wooden staves	l	140	140
Transparent roof-light in bathroom	cm	28 x 28	28 x 28
12 V sockets / 230 V sockets / USB socket		2 / 5 / (1+2)	2 / 6 / (1+2)
TV sockets in living room - rear bedroom		1 / -	1 / -

## OPTIONAL

Optional Chassis		Fiat Ducato 43 Heavy	Fiat Ducato 43 Heavy
Maximum power	kW (hp)	117 (160), 130 (180)	117 (160), 130 (180)
Weight in running order <sup>(J)</sup>	kg	2.908	3.023
Payload (approx.) <sup>(F)</sup>	kg	1.342 <sup>S</sup> / 1.492 <sup>O</sup>	1.227 <sup>S</sup> / 1.377 <sup>O</sup>
Maximum total weight <sup>(C)</sup>	kg	4.250 <sup>S</sup> / 4.400 <sup>O</sup>	4.250 <sup>S</sup> / 4.400 <sup>O</sup>

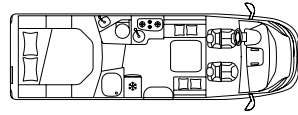
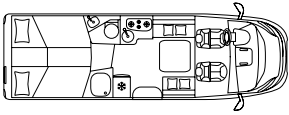

## 509 LE

741 / 233 / 294
218 / 213
4,035
3.014
486 <sup>S</sup> / 636 <sup>O</sup>
3.500 <sup>S</sup> / 3.650 <sup>O</sup>
4 <sup>S</sup> / 5 <sup>O</sup>
34 / 33 / 49
218 × 118 × 109
93 × 115 / 93 × 115
2 <sup>S</sup> + 2 <sup>O</sup> + 1 <sup>O</sup>
205 × 80 / 210 × 80
O
-
200 × 115 <sup>O</sup>
200 × 140
Z-
140
28 × 28
2 / 6 / (1+2)
1 / -
Fiat Ducato 43 Heavy
117 (160), 130 (180)
3.044
1.206 <sup>S</sup> / 1.356 <sup>O</sup>
4.250 <sup>S</sup> / 4.400 <sup>O</sup>

## 512 E

741 / 233 / 294
218 / 213
4.035
3.014
486 <sup>S</sup> / 636 <sup>O</sup>
3.500 <sup>S</sup> / 3.650 <sup>O</sup>
4 <sup>S</sup>
34 / 33 / 49
218 × 90 <sup>min</sup> / 120 <sup>max</sup> × 109
93 × 115 / 93 × 115
2 <sup>S</sup> + 2 <sup>O</sup> + 1 <sup>O</sup>
- / -
-
190 × 148
200 × 115 <sup>O</sup>
200 × 140
-
140
28 × 28
1 / 5 / (1+2)
1 / -
Fiat Ducato 43 Heavy
117 (160), 130 (180)
3.044
1.206 <sup>S</sup> / 1.356 <sup>O</sup>
4.250 <sup>S</sup> / 4.400 <sup>O</sup>



# PACKS

## CHASSIS PACK

+ 28,9 KG

- Manual single-zone air conditioning for cab, Fiat original part
- Traction+, Hill Descent
- Cruise control
- Electric and heated rear view mirrors
- Height adjustable passenger's cab seat, Fiat original part
- Provision for DAB radio and cab loudspeakers
- Radio DAB aerial integrated in the right rearview mirror
- Steering wheel radio control
- Passengers airbag

---

**Pack value** 2.663 €

**Saving** -647 €

---

**Pack price** **2.016 €\***

## DESIGN PACK

+ 0,3 KG

- Steering wheel and gear lever in real leather, Fiat original part
- Dashboard display with chrome-coloured profile, Fiat original part
- Dashboard "Techno" with aluminium frames around warm air vents, Fiat original parts
- Engine grill colour glossy black
- Headlights with black frame design
- LED daytime running lights, Fiat original part

---

**Pack value** 1.000 €

**Saving** -329 €

---

**Pack price** **671 €\***

## SECURITY PACK

+ 1,5 KG

- Driving assistance: full brake control, highbeam/lowbeam, LDWS, signal recognition, rain and light sensor
- TPMS tyre pressure checking system

---

**Pack value** 1.092 €

**Saving** -253 €

---

**Pack price** **839 €\***

## SAFETY PACK

+ 4,2 KG

- Parking sensors, front (4 pieces)
- Parking sensors, rear (4 pieces)
- Antitheft system, volumetric and perimetric, with remote control integrated in the chassis key
- Antitheft window sensors (6 pieces, only possible with anti-theft system)

---

**Pack value** 1.680 €

**Saving** -504 €

---

**Pack price** **1.176 €\***

(3) Allows to turn on / off the heating system via Bluetooth or GSM (SIM). The dedicated SIM is not provided by Laika.

## WINTER PACK

### (AIR HEATING SYSTEM)

+ 13,0 KG

- Heating Combi 6E
- Heated floor (part of floor)
- Device permitting remote control of the heater via smartphone <sup>(3)</sup>

---

Pack value	1.344 €
Saving	-504 €

---

Pack price

839 € \*

## SUMMER PACK

+ 66,5 KG <sup>200E</sup> | + 70,5 KG <sup>500E</sup>

- 2,200 W Air conditioning living area
- External Shower (cold water)
- Awning (manual) 4 m, exterior paint white (Kosmo Emblema 200) / Awning (manual) 4.5 m, exterior paint white (Kosmo Emblema 500)

---

Kosmo 200E | 500E

Pack value	3.024 €   3.192 €
Saving	-672 €   -672 €

---

Pack price

2.352 € \* | 2.520 € \*

## WINTER PACK

### (WATER HEATING SYSTEM)

+ 67,0 KG

- Heating system, hot water heating
- Heated Floor (part of floor)
- Device permitting remote control of the heater via smartphone <sup>(3)</sup>

---

Pack value	3.269 €
Saving	-833 €

---

Pack price

2.436 € \*



# ACCESSORIES

Code No.	Accessories	Price €*	Kg	209 E	509 E	509 LE	512 E
<b>CHASSIS AND CAB</b>							
1LR	16" Alloy wheels Fiat original parts, Heavy chassis (4 pieces)	300 €	0,0 kg	0	0	0	0
140	Automatic air conditioning for cab, Fiat original part (price difference on manual air conditioning)	406 €	0,0 kg	0	0	0	0
AT9-140	Automatic transmission for engine 140 BHP (possible only with Eco Pack cod. 0AA), 16" tyres obligatory	2.800 €	48,0 kg	0	0	0	0
AT9-160-180	Automatic transmission for engine 160 BHP and 180 BHP, 16" tyres obligatory	2.800 €	33,0 kg	0	0	0	0
09U	Cab seats with heated seats, original Fiat part (2 pieces)	580 €	1,0 kg	0	0	0	0
2734600	Chassis Fiat Heavy 4,250 kg	1.210 €	40,0 kg	0	0	0	0
2734602	Chassis Fiat Heavy 4,400 kg (possible only with 160 BHP or 180 BHP)	1.426 €	40,0 kg	0	0	0	0
3065127	Diesel tank 90 l, Fiat chassis	84 €	12,0 kg	0	0	0	0
0AA	Eco Pack Start & Stop function incl. booster (not in conjunction with 120 bhp, 140 bhp optional, 160 bhp and 180 bhp standard)	280 €	2,0 kg	0	0	0	0
5QD	Engine battery cut off switch, Fiat original part	50 €	0,0 kg	0	0	0	0
3056219	Engine Fiat 2.3, 160 BHP, Euro 6d Temp, including Eco Pack	2.430 €	15,0 kg	0	0	0	0
3056223	Engine Fiat 2.3, 180 BHP, Euro 6d Temp, including Eco Pack	3.930 €	15,0 kg	0	0	0	0
FD6	Fifth seat with removable seat	583 €	11,0 kg	-	0	-	-
75P	Fog lights, Fiat original part	243 €	0,6 kg	0	0	0	0
2043605	Increased weight 3,650 kg, Fiat Light chassis	217 €	0,0 kg	0	0	0	0
320	Steering wheel and gear lever in real leather, Fiat original part	248 €	0,3 kg	0	0	0	0

## INTERIOR ACCESSORIES

2989114	19" TV LED DVD, with decoder and adjustable TV stand, entrance area	756 €	7,5 kg	0	0	0	0
2989118	22" TV LED DVD, with decoder and adjustable TV stand, entrance area	689 €	7,5 kg	0	0	0	0
3171460	32" TV LED DVD, with decoder and adjustable TV stand, entrance area	1.175 €	10,3 kg	0	0	0	0
FD1	Adjustable TV stand at entrance area/above fridge	137 €	3,0 kg	0	0	0	0
FD7	Bed in the lounge (single bed) with telescopic table leg	295 €	10,0 kg	-	0	0	0

(5) With the drop-down bed over the living room, the roof-light 70x50 cm is replaced by the roof-light 40x40 cm.

S = Standard

O = Option

- technically not possible

Code No.	Accessories	Price €* Kg	209 E	509 E	509 LE	512 E
F04	Drop-down bed, electric, above the lounge <sup>(5)</sup>	1.310 € 40,0 kg	O	O	O	O
55513	Gas detector	188 € 2,0 kg	O	O	O	O
FO	Gas oven with grill	530 € 17,0 kg	O	O	O	O
FC5	Rear double bed with ladder	259 € 9,0 kg	O	O	O	-
C30	Second battery for living area	263 € 27,0 kg	O	O	O	O
2333651	Table with folding top and telescopic leg (bed in lounge not possible)	238 € 10,0 kg	O	O	O	-
EX	Upholstery Alba	383 € 0,0 kg	O	O	O	O
EE	Upholstery Firenze, leatherette	550 € 0,0 kg	O	O	O	O
TT2	Upholstery Udine	550 € 0,0 kg	O	O	O	O
KN	Upholstery Vip Club, real leather, made in Italy	2.366 € 4,0 kg	O	O	O	O

## EXTERIOR ACCESSORIES

2059419	120 W Solar panel with control and fixing brackets	726 € 15,5 kg	O	O	O	O
D11	Awning (manual) 4 m, exterior paint white	818 € 30,0 kg	O	-	-	-
C49	Awning (manual) 4.5 m, exterior paint white	962 € 34,0 kg	-	O	O	O
37831	Bicycle rack, foldable, with 3 bike rails	330 € 9,3 kg	O	O	O	O
37832	Bike rack fourth holder	77 € 1,0 kg	O	O	O	O
F33	Gas regulator	335 € 5,0 kg	O	O	O	O
F44	External gas socket	193 € 1,0 kg	O	O	O	O
AN3	Satellite aerial 80 HD	1.950 € 17,0 kg	O	O	O	O
F23	Stabilising jacks	251 € 6,0 kg	O	O	O	O
67201	Tow hitch	1.106 € 35,0 kg	O	O	O	O