

Camper Vans Price List Technical Data

Valid starting from 15.08.2020



www.xcamp.pl



KOSMO CAMPER VANS

STANDARD KOSMO CAMPER VANS DATA

Standard chassis (Kosmo 5.4, Kosmo 6.0 Kosmo 6.4)		Fiat Ducato 33 Light 35 Light
Engine displacement	cc	2.287
Maximum power	kW (HP)	88 (120)
Towable mass ^(H)	kg	2.500
Fresh water tank capacity (antifreeze) ^(K)	l	80 + 20
Waste water tank capacity	l	90
Combi heating system	kW	6

Model shown: Kosmo Camper Van 6.0 featuring non standard options.





CHASSIS

- Fiat Ducato 'mechanics', 120 HP, Turbo Diesel Common Rail, Euro 6d Temp
- Front wheel drive
- Electronic Stability Control: ESP, ABS, ASR, Hill Holder e Roll Over Mitigation
- 6 speed manual gearbox
- Driver side airbag
- 75 l diesel tank
- Electric cab windows
- Daytime running lights
- Headlight levellers
- Cup holder in cab
- 12 V and USB outlets in cab (max 180 W)
- Swivel cab seats with headrest, two armrests, reclining backrest, height adjustable driver's cab seat
- Tyre repair set Fix & Go

DESIGN & BODYWORK

- White body including body coded bumpers. (Silver metallic optional)
- Stylish Laika Kosmo graphics
- High quality framed windows with blind and mosquito net
- Winter usage is also possible (with heated water tank and comfort pack)
- Central locking
- Storage compartments in in rear and side doors.

KITCHEN & BATHROOM

- Scratch and fingerprint resistant kitchen and table tops
- Hinged worktop extension
- High gloss white kitchen
- Stainless steel kitchen sink
- 2-burner stove, piezoelectric
- Compressor refrigerator in front position reachable from both inside and outside the vehicle
- Automatic soft-close drawers
- 230 V outlet in kitchen
- Clothes rail in bathroom
- Sliding folding toilet door
- Cassette toilet with swivel bowl and removable cassette
- Thermoformed shower wooden foot-board

SYSTEMS

- Gas combi heating system and programmable digital control panel
- LED lighting
- Indirect dimmable ceiling lighting
- Easy to use control panel with LED indicators
- Automatic 18 A battery charger
- High performance leisure battery (95 Ah), without maintenance
- USB sockets power supply and charging of mobile devices
- ABS moulded gas compartment for 2 x 10kg cylinders.
- Fresh water tank complete with electric immersion pump, single lever taps
- Underslung waste water tank featuring safety open/ close button.

INTERIOR & COMFORT

- Pero Toscana furniture design
- Noto upholstery with stain protection treatment
- High gloss locker doors
- Lounge cushions with removable lining
- Height-adjustable living room headrests
- Functional table with extension
- Raised floor with courtesy light with courtesy light and integrated double stowage space in living area
- 40x40 cm roof-light in living area with mosquito net and blind (not possible with pop-top roof)
- 40x40 cm roof-light in rear area with mosquito net and blind (not possible with pop up roof)
- High comfort, breathable mattresses, breathable mattresses with machine washable stretch lining
- Rear beds with wooden staves
- Vertical partition wall (low) in living/ sleeping area
- Adjustable reading lights on rear bed and in living area
- Back storage space with four integratedfixing holes
- Rear bed can be easily dismantled to allow the loading of particularly bulky objects
- Increased headroom and sense of space in cab cut for maximum airiness inside, upholstered and padded in technical fabric, complete with LED lighting and open-top storage
- Isofix attachments for living room car seat
- Pop-top roof bed optional

OVERVIEW OF ALL MODELS

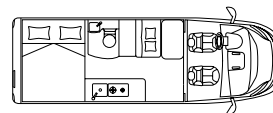
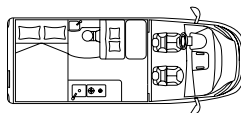

MODELS

KOSMO 5.4

KOSMO 6.0

Standard chassis		Fiat Ducato 33 Light	Fiat Ducato 33 Light
External length / width / height ^{(D) (E)}	cm	541 / 205 / 265	599 / 205 / 265
Internal height	cm	190	190
Wheelbase	mm	3.450	4.035
Weight in running order ^(J)	kg	2.630	2.700
Payload (approx.) ^(F)	kg	670	600
Maximum total weight	kg	3.300	3.300
Type-approved seats ^(B)		4 ^S	4 ^S
Berths		2 ^S + 1 ^O + 2 ^O	2 ^S + 1 ^O + 2 ^O
Dinette bed		185 × 87 63 ^O	185 × 105 88 ^O
Rear double bed with wooden staves	cm	195 × 133 ^{max} / 130 ^{min}	197 × 157 ^{max} / 150 ^{min}
Bed on pop-top roof ^(O)	cm	200 × 135	200 × 135
Refrigerator l	l	90	90
Transparent roof-light in bathroom	cm	28 × 28	28 × 28
12 V sockets - 230 V sockets - USB socket		1 / 3 / 1	1 / 3 / 1

CHASSIS OPTIONS

Optional chassis		35 Light 43 Heavy	35 Light 43 Heavy
Maximum power	kW (HP)	103 (140), 117 (160), 130 (180)	103 (140), 117 (160), 130 (180)
Weight in running order ^(J)	kg	2.630 2.670	2.700 2.740
Payload (approx.) ^(F)	kg	870 830	800 760
Maximum total weight	kg	3.500	3.500

S = Standard O = Option – technically not possible

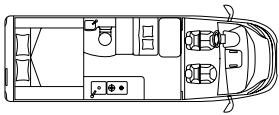

KOSMO 6.4

Fiat Ducato 35 Light

636 / 205 / 265

190

4.035

2.790

710

3.500

4^s

2^s + 1^o + 2^o

180 × 80^o

195^{max} / 188^{min} × 185

200 × 135

90

28 × 28

1 / 3 / 1

43 Heavy

103 (140), 117 (160), 130 (180)

2.830

670

3.500



PACKS

CHASSIS PACK

+ 28.9 KG

- Manual single-zone air conditioning for cab, Fiat original part
- Traction+, Hill Descent
- Cruise control
- Electric and heated rearview mirrors
- Height adjustable passenger's cab seat, Fiat original part
- Provision for DAB radio aerial
- DAB aerial on right rearview mirror, Fiat original part
- Steering wheel radio control
- Passenger airbag

MULTIMEDIA PACK

+ 7.8 KG

- 8" Multimedia System
- DAB radio
- Touchscreen
- Navigation system and map update 3 years
- Rear camera

COMFORT PACK

+ 49.4 KG

- Shower with pull up curtains
- Window in bathroom ⁽⁸⁾
- Wooden foot board in shower
- Electric entrance step
- Mosquito net
- Table rotatable
- Roof-light 70x50 cm in living area
- Matching cab seat upholstery
- Carpet for driving cab and small carpet for internal step at entrance door
- Preparation for rear camera
- Insulation for waste water tank
- USB socket
- Coat hanger

Roof-light 70x50 cm only possible without pop-top roof (41,4 kg without roof-light).

SMART HOME PACK

+ 6.0 KG

- Gas detector
- Digital control for heating system
- Gas Regulator
- Pre-wiring for TV including TV bracket

DESIGN PACK

+ 0.3 KG

- Leather steering wheel and gear knob, Fiat original part
- Chrome rings on dashboard, Fiat original part
- 'Techno' dashboard with aluminium frames around warm air vents, Fiat original parts
- Black high gloss grille
- Black headlamp frames
- LED daytime running lights, Fiat original part

SAFETY PACK

+ 4.0 KG

- Parking sensors, front (4 pieces)
- Parking sensors, rear (4 pieces)
- Antitheft system, volumetric and perimetric, with remote control integrated in the chassis key

DESIGN PACK SILVER

+ 10.3 KG ^{LIGHT} | + 0.3 KG ^{HEAVY}

- Leather steering wheel and gear knob, Fiat original part
- Chrome rings on dashboard, Fiat original part
- 'Techno' dashboard trim with aluminium frames around warm air vents, Fiat original parts
- High gloss black grille
- Black headlamp frames
- LED daytime running lights, Fiat original part
- Silver body coded bumper
- Alloy wheels 16" Fiat original parts, Light chassis, incl. 16" tyres (4 pieces) / Alloy wheels, 16" Fiat original parts, Heavy chassis

Required increase to 3,500 kg for Kosmo 5.4 and 6.0 (Kosmo 6.4: 3,500 kg standard).

SECURITY PAKET

+ 2.5 KG

- Driving assistant, blind spot and rear assist
- Driving assistance: full brake control, highbeam/lowbeam, LDWS, signal recognition,
- Rain and light sensor
- TPMS tyre pressure monitor

KOSMO CAMPER VANS

ACCESSORIES

Code No.	Accessories	Price £*	Kg	5.4	6.0	6.4
CHASSIS AND CAB						
140	Air conditioning for cab, automatic, Fiat original part (price difference on manual air conditioning)	426 £	2.0 kg	○	○	○
431	Alloy wheels 16" Fiat original parts, Light chassis, incl. 16" tyres (4 pieces) (not possible for chassis 3,300 Kg)	473 £	12.0 kg	○	○	○
1LR	Alloy wheels 16" Fiat original parts, Heavy chassis (4 pieces)	315 £	0.0 kg	○	○	○
AT9-HE140	Automatic gearbox Heavy - 140 HP (possible only with Eco Pack cod. OAA)	2,940 £	18.0 kg	○	○	○
AT9H160180	Automatic gearbox Heavy - 160 and 180 HP (incl. alloy wheels)	2,940 £	3.0 kg	○	○	○
2JH-1	Automatic transmission 140 HP (incl. alloy wheels, possible only with Eco Pack cod. OAA)	2,940 £	58.0 kg	○	○	○
2JH-2	Automatic transmission 160, 180 HP (incl. alloy wheels)	2,940 £	43.0 kg	○	○	○
C93	Cab blinds	353 £	5.6 kg	○	○	○
09U	Heated cab seats original Fiat part (2 pieces)	609 £	1.0 kg	○	○	○
3051266	Chassis Fiat Heavy 3,500 kg	1,271 £	40.0 kg	○	○	○
3051269	Chassis Fiat Light, total weight 3,500 kg instead of 3,300 kg	525 £	0.0 kg	○	○	-
3065127	Diesel tank 90 l, Fiat chassis	88 £	12.0 kg	○	○	○
0AQ	Driving assistance: full brake control, highbeam/lowbeam, LDWS,	840 £	1.0 kg	○	○	○
0AA	Eco Pack Start & Stop function incl. booster (not in conjunction with	294 £	2.0 kg	○	○	○
5QD	Engine battery cut off switch, Fiat original part	53 £	0.0 kg	○	○	○
3057312	Engine Fiat 2.3, 140 HP, Euro 6d Temp	683 £	0.0 kg	○	○	○
3056219	Engine Fiat 2.3, 160 HP, Euro 6d Temp, including Eco Pack	2,552 £	15.0 kg	○	○	○
3056223	Engine Fiat 2.3, 180 HP, Euro 6d Temp, including Eco Pack	4,127 £	15.0 kg	○	○	○
2999395	External windscreen cover	88 £	1.5 kg	○	○	○
75P	Fog lights, Fiat original part	255 £	0.6 kg	○	○	○
2013861	Laika logo stickers for Fiat wheel covers or alloy wheels (4 pieces)	34 £	0.1 kg	○	-	○
320	Steering wheel and gear lever in real leather, Fiat original part	260 £	0.3 kg	○	○	○
2064193	Upgraded rear double leafspring suspension	93 £	0.0 kg	○	○	○

Code No.	Accessories	Price £*	Kg	5.4	6.0	6.4
INTERIOR ACCESSORIES						
C78	Battery extra 90 A and battery charger	384 £	26.0 kg	O	O	O
C73	Bed in the lounge (single bed)	310 £	3.0 kg	O	O	O
D42	Diesel heating (possible only with 52X)	582 £	1.0 kg	O	O	O
C74	Heated waste water tank	485 £	1.0 kg	O	O	O
C31	Combi 6E Heating	476 £	2.0 kg	O	O	O
C12	Oven	440 £	14.0 kg	-	-	O
TEFG	Pop-top roof, silver with double bed and comfort rest system ⁽¹⁾	4,410 £	160.0 kg	O	O	O
TEF	Pop-top roof, white with double bed and comfort rest system ⁽¹⁾	3,528 £	160.0 kg	O	O	O
52X	Provision for gasoline heating on Fiat chassis	88 £	3.5 kg	O	O	O
C69	Rear window left side	352 £	5.0 kg	O	O	-
C72	TV LED 19" and TV stand	793 £	8.0 kg	O	O	O
EX	Upholstery Alba	402 £	0.0 kg	O	O	O
EE	Upholstery Firenze	578 £	0.0 kg	O	O	O
TT2	Upholstery Udine	578 £	0.0 kg	O	O	O
KN	Upholstery Vip Club, real leather, made in Italy	2,484 £	4.0 kg	O	O	O

EXTERIOR ACCESSORIES

53773	Antitheft window sensors (6 pieces, only possible with anti-theft system)	266 £	0.2 kg	O	O	O
0C4	Awning (manual) 3.25 m, exterior paint anthracite ⁽¹⁾	895 £	24.0 kg	O	-	-
C83	Awning (manual) 3.75 m, exterior paint anthracite ⁽¹⁾	985 £	30.0 kg	-	O	O
C79	Provision for solar panel	87 £	2.0 kg	O	O	O
2837302	Tow hitch	818 £	50.0 kg	-	O	O

INFORMATION

Technical data sheets legend

- (B) If accessories are installed, the number of the type-approved seats may change.
- (D) On Heavy chassis or with 16" tyres, the total height increases by 5 cm.
- (E) Accessories mounted on the roof, for example satellite aerial, solar panel, etc., modify the height of the vehicle.
- (F) Accessories installed reduce the indicated payload.
- (H) By mounting the tow hitch the weight in running order changes, so it is possible that the type-approved seats may change.
- (J) The mass in running order includes: 75 kg driver, 90% fuel tank, 100% fresh water tank of the capacity suitable for running and 100% gas cylinder.
- (K) Before starting to drive, check that the level of the fresh water tank does not exceed 20 l.

Accessories legend

- (1) The installation of both accessories, awning and pop-top roof, reduces the length of the awning of 25 cm.

Technical information

- 1) The weights of the vehicles in running order (reg. EU 1230/2012) include: 75 kg driver, 90% of fuel tank capacity, gas cylinder capacity, capacity of tank for fresh water considered suitable for running.
- 2) Anything not included in the standard vehicle version (whether referring to mechanics or to the living space) can cause an increase in weight in running order with a resulting reduction of the useful load. This reduction may result in the need to reduce the number of approved seats, if the total weight of Accessorieses and options exceeds the value of the residual useful load. It is therefore advisable to consult the weights of individual options and Accessorieses listed in the price list before installing any Accessorieses. Please remember that the law does not permit exceeding the technically permissible maximum mass value. It is therefore advisable not to exceed the Technically Permissible Maximum Mass and that sufficient useful load remains for passengers and luggage. In the event of installation of a bike rack or of declassing of the Heavy chassis, the approved seating number may vary. In this case, always check with the dealer regarding any changes to approved seats.
- 3) The calculation of useful load is given by the difference between the Technically Permissible Maximum Mass at full load and the Mass in Running Order. This figure includes 75 Kg for each passenger (not including the driver), and

the minimum useful load (given by the formula 10 Kg for each metre of length of the vehicle plus 10 Kg for each passenger, usable by the crew for luggage and equipment), which will be separated to obtain the residual useful load. The residual useful load can be used for the installation of Accessorieses and for loading more luggage.

- 4) In order to maintain optimal setup of the vehicle in running and stationary conditions, it is advisable to distribute the payload in a uniform manner over the surface of the vehicle.
- 5) The technical specifications indicated on this sheet regarding the measurements and weights of the vehicles as well as their supplied equipment and appearance correspond to the current knowledge at the time of printing (august 2020). The technical specifications can, however, vary, with a tolerance of +/- 5%.
- 6) The data regarding towable mass are a valid indication for upward slopes with a maximum incline of 12%. 7) Laika reserves the right to make changes to equipment or improvements to products. Before making your purchase official, we recommend that you inquire with your preferred Laika dealer for the latest update regarding standard provided equipment and to verify whether any changes have been made with respect to the specifications contained in this sheet.
- 8) Parts in contact with one another may display different shades of colour due to differences amongst the materials used.
- 9) The overall vehicle height is increased in case of installation of Accessorieses on the roof, such as – for example - satellite antennas and solar panels. With 16" tyres on Fiat Ducato, the overall height of the vehicle increases by approximately 5 cm.
- 10) The number of approved seats can vary depending on the regulations of the individual states regarding road travel.
- 11) Installed, transformed, or added Accessorieses that have not been approved by Laika can compromise or reduce safety margins and cause damage, even if there is notification proving the possibility of installation of an accessory.
- 12) Please note that, in case of installation of an accessory - especially in the back area, like for example of bike racks, tow hitch, and so on - you must always be sure you observe the maximum load permitted on the axle.
- 13) Any changes made after production can reduce vehicle safety margins.
- 14) Please make sure, referring to the weights of individual Accessorieses listed in the price list or asking your authorised Laika dealer, that the "overall permitted mass" is not exceeded and that sufficient useful load remains for passengers and luggage.

Accessories notes

! Installing accessories
reduces the load capacity

If accessories are installed, it is mandatory to follow the instructions and recommendations indicated by the manufacturer of the accessory installed.

General information

Laika Caravans S.p.A. reserves the right, at any time and with no notice, to improve and change the specifications of the cell and frames, furniture and interior design characteristics and the equipment of the vehicles presented in this catalogue. In spite of our careful control, this catalogue may contain misprints. Some of the vehicles shown in the pictures of this catalogue are prototypes not yet serially manufactured at the printing date of this catalogue (August 2020). Some of the vehicles shown in the pictures have Accessorieses not included in the standard equipment, which therefore can be supplied only at an extra price. The pictures may even show pieces of furniture (e.g. plates, glasses) and other objects, such as TV sets or motorbikes, that are not included in the standard equipment of the vehicles and not marketed by Laika. This catalogue contains the standard equipment and specification characteristics supplied at the print date. The data in the technical data sheets refer to the European type approval, which is valid in all EU Countries. Some data might differ in non-EU Countries due to different applicable regulations. In this case, we recommend contacting the nearest Laika dealer for information concerning local registration laws and the related type-approval data. Your dealer will inform you about any change made to the products after printing the catalogues. All the Options are available at an extra price. For any particular or special use the Customer should inform the dealer before signing the purchase contract.

If accessories are installed, it is mandatory to follow the instructions and recommendations indicated by the manufacturer of the accessory installed.

Price notes

The prices shown in this price list are expressed in GBP and include the transportation cost to the Retailer and 20% VAT. Laika Caravans S.p.A. reserves the right to, and does alter from time to time, technical specifications, prices and model ranges as materials, model improvements and conditions require. This price list does not constitute an offer by Laika Caravans S.p.A. and should be used for guidance purposes only. Please confirm full specification and pricing with your approved Laika Retailer before placing your order. This price list supersedes any previous versions.

Laika Caravans S.p. A.
Via Certaldese 41/A
San Casciano in Val di Pesa
50026 Firenze, Italia

laika@laika.it
www.laika.it

Facebook: LaikaCaravan
Instagram: laika_Caravans

UK - AUGUST 2020 ENG



Enjoy the Dolce Vita.