

KREOS 5000 LOW-PROFILES

STANDARD KREOS LOW-PROFILES 5000 DATA

Standard chassis		Fiat Ducato 43 Heavy AL-KO
Engine displacement	cc	2.287
Maximum power	kW (hp)	103 (140)
Towable mass ^(H) ^(I)	kg	2.000
Fresh water tank capacity (antifreeze) ^(K)	l	120 + 20
Waste water recovery tank capacity (heated and anti-freeze) with external vent	l	140
Water heating system	kW	6

Model shown: Kreos 5009



EQUIPMENT



CHASSIS

- Fiat Ducato mechanics Heavy, AL-KO, Turbo Diesel Common Rail, Euro 6d Temp
- Silver driving cab with silver painted bumpers
- Front wheel drive
- AL-KO chassis with enlarged rear track and reinforced suspensions
- Electronic Stability Control: ESP specific for campers, ABS, EBD, Traction+, Hill Holder, Hill Descent, Roll Over Mitigation
- Cruise control
- Front sway bar
- 6-speed + 1 manual gearbox
- Automatic cab climate control
- Driver and passenger airbags
- 90 l diesel tank
- Electrical power windows
- Heated, electrically adjustable rear view mirrors with wide angle and radio aerial integrated
- LED day running lights, headlight levelers
- Driver's cabin with dashboard with briar-effect inserts, instrument panel with chrome profiles, air vents with aluminium finish, carpet
- 12 V and USB outlet in cab (max 180 W)
- Two speakers in cab
- Swivel cab seating with armrests, seatbelts, adjustable in height, backrest and fabric coordinated with living room
- Adjustable height steering wheel, steering wheel and gear lever in real leather
- Steering wheel radio control
- 16" Alloy wheels, Fiat original parts, Heavy chassis
- Eco Pack: Start&Stop, intelligent alternator control, electronically controlled fuel pump

DESIGN & BODYWORK

- Polyurethane wall and roof framework, high insulation in extruded polystyrene foam (XPS), roof lined in hail protection fibreglass, aluminium external walls, anti-yellowing
- Double floor with total fibreglass cov-

- ering and complete insulation, heated and lightened cavity with external and internal access to the floor
- Highly insulated and heated overcab and cab/living area connection areas
- LED automotive rear light
- High quality frame windows with silver polyurethane frame, blind and mosquito net
- Premium living space door with two-point closure with remote control, window, blind, storage compartment and sliding mosquito net
- External LED light
- Electrical step with acoustic warning when the engine is running and recall directly from the dashboard
- Coated aluminium car side skirts including maxi hatches dedicated to external access to the double floor and gas stop pistons
- Centralised cab and living space door closure
- Garage with a payload capacity of 250 kg, lowered, heated and insulated loading surface, with two large hatches, floor insulated, 12V, 230V sockets and TV, dual LED lighting, coat hanger rod with sliding rings, fixing bars with rings, two storage nets
- Garage door open dashboard warning light

KITCHEN & BATHROOM

- Large 160 l trivalent refrigerator with automatic energy source selection
- Large kitchen with scratch and fingerprint resistant Corian top, integrated double sink and dish rack, large worktop, sink cover that can be used as an additional shelf and diffused lighting
- 3-burner stove
- Gas oven
- Large kitchen storage spaces with drawers and pull-out baskets with automatic soft-closure drawers
- Ideal ventilation thanks to the roof-light, extractor hood and opening window
- 230 V outlet in kitchen
- Large sized bathroom sink in nautical

style porcelain material with soft-touch effect

- Shower, XL, 200 cm high with internal white/blue lighting, double drain plug, wooden footboard, towel rod and household type smoky door with chrome profiles
- Dual bathroom light switch: inside and outside bathroom
- Toilet with swivel cup and removable cassette 18 litres (frost-resistant)
- Bathroom door also to be used as a separation for the centre of the vehicle
- Toilet with wooden furniture, mirrored wall cabinets, window and roof-lights

SYSTEMS

- Performance-optimised convector heating, Laika exclusive, with radiant elements positioned in all areas of the vehicle to guarantee maximum comfort in all conditions with certification obtained in chamber tests
- Programmable heating
- Rear area heating regulation system
- Heat exchanger
- High-tech, 100% LED lighting design system, mostly all dimmerable, with light on/off outlets in different positions
- Fully antifreeze water system
- Increased water tanks positioned on heated panels
- Pressurised water pump with expansion vessel, high quality single lever metal faucets
- Water system easily accessible from the rear garage for every inspection, cleaning and maintenance operation
- Gas system with anti-crash sensor and automatic cylinder exchanger
- Two USB outlets in the rear bedroom and one USB outlet in the living area
- Automatic 20 A battery charger

EQUIPMENT

INTERIOR & COMFORT

- Indirect multi-level lighting in living room, kitchen and bedroom, dimmable, for individual management of the atmosphere on board
- Comfortable internal headroom with 210 cm for maximum airiness
- Insulated/upholstered ceiling with elegant Laika-Iso-Deluxe material
- Single level flooring without stairs
- Furniture design Noce Italiano
- Firenze upholstery with stain protection treatment
- Large wall units with exclusive, high quality mechanical components and indirect interior lighting
- Wall units in kitchen and living room with exclusive "Bianco Carrara" coating, soft-closures
- Living room with upholstery and home comforts, adjustable headrests, cushions with removable lining and indirect lighting
- Ergonomic table with moving table top and easy handling
- Two maxi panoramic roof-light that can be opened, one of which is integrated into the driver's cabin
- TV compartment for LED screen and extraction and height adjustment system for a perfect view both from the living room and from the drop-down bed
- Heated double floor with heat storage function, storage compartment internally accessible through two floor hatches
- Internal pleated sliding blackout protection in the cab, for the windscreen and side windows
- Entrance with integrated step, complete with doormat, lighting, courtesy handle and two comfortable shoe compartments
- Easy accessibility to back beds
- Back beds with extremely comfortable spring system
- Nautical type night-time floorlights
- Ultra thick back "Wellness" anti-bacterial, anti-mite, breathable mattresses with machine washable stretch lining with silver ions
- Large 96x65 cm roof-light in back room
- Adjustable reading lights on all beds

STANDARD SETTINGS FOR:

- Provision for DAB radio aerial and cab loudspeakers
- Tow hitch
- Internal wall units-roof-power supply wiring passage
- Rear parking sensors
- Additional waste water tank with level reading
- Reversing camera
- Turbovent
- TV in living area (hidden TV)
- TV in rear bedroom
- Radio

(a) = With the optional "Grand Chef" kitchen with built-in oven, the standard oven above the fridge is replaced by a compartment with wooden door. Otherwise this compartment can be used for the optional microwave oven.

OVERVIEW OF ALL MODELS

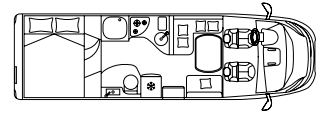
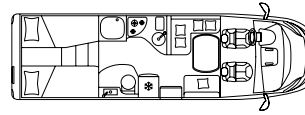

MODELS

KREOS 5009

KREOS 5010

External length / width / height ^(E)	cm	769 / 230 / 303	769 / 230 / 303
Internal width / height	cm	217 / 210	217 / 210
Wheelbase	mm	4.500	4.500
Weight in running order ^(J)	kg	3.334	3.307
Payload (approx.) ^(F)	kg	916 ^{140Hp} / 1.166 ^{160-180Hp}	943 ^{140Hp} / 1.193 ^{160-180Hp}
Maximum total weight	kg	4.250 ^{140Hp} / 4.500 ^{160-180Hp}	4.250 ^{140Hp} / 4.500 ^{160-180Hp}
Type-approved seats ^(B)		4 ^S / 5 ^O	4 ^S / 5 ^O
Wall / roof / floor (thickness)	mm	35 / 40 / 52	35 / 40 / 52
Double floor height (max / min)	mm	360 / 210	360 / 210
Garage dimensions (W x H x L)	cm	217 x 125 x 134	217 x 125 x 154 / 127
Right hatch / left hatch (W x H)	cm	95 x 110 / 63 x 104	95 x 120 / 63 x 104
Berths		2 ^S + 2 ^O + 1 ^O	2 ^S + 2 ^O + 1 ^O
Rear right side bed / rear left side bed with spring system and raising back	cm	197 x 85 / 197 x 85	-
Double rear bed with spring system	cm	-	210 x 150
Dinette bed	cm	190 x 110 / 80 ^O	190 x 110 / 80 ^O
Electric-powered drop-down bed above the living room ^O	cm	190 x 136 / 80	190 x 136 / 80
Wardrobe with dual access (from front and top)		2	-
Sliding door to separate living and sleeping areas		S	-
Refrigerator with automatic source selection and external inspection grid		160 l HPC + oven	160 l HPC + oven
12 V sockets / 230 V sockets / USB socket		5 / 4 / 1+3	5 / 4 / 1+4
TV sockets in living room - rear bedroom		1 - 2	1 - 2

OPTIONAL

Optional Chassis		Fiat Ducato 43 Heavy AL-KO	Fiat Ducato 43 Heavy AL-KO
Maximum power	kW (hp)	117 (160) / 130 (180)	117 (160) / 130 (180)
Weight in running order ^(J)	kg	3.334	3.307
Payload (approx.) ^(F)	kg	1.166	1.193
Maximum total weight	kg	4.500	4.500

S = Standard

O = Option

- technically not possible

PACKS

SECURITY PACK

+ 1,5 KG

- Driving assistance: full brake control, highbeam/lowbeam, LDWS, signal recognition, rain and light sensor
- TPMS tyre pressure checking system, Fiat AL-KO chassis

Pack value	1.344 €
Saving	-336 €

Pack price

1.088 €*

SAFETY PACK

+ 4,2 KG

- Parking sensors, front (4 pieces)
- Parking sensors, rear (4 pieces)
- Antitheft system, volumetric and perimetric, with remote control integrated in the chassis key, including garage doors and hatches
- Antitheft window sensors (6 pieces, only possible with anti-theft system)

Pack value	1.680 €
Saving	-504 €

Pack price

1.176 €*

MULTIMEDIA PACK

+ 7,8 KG

- 9" Multimedia system
- Touch screen
- GPS
- Rear camera
- DAB radio
- Sound activators

Pack value	1.680 €
Saving	-168 €

Pack price

1.512 €*

SMART HOME PACK

+ 11,0 KG

- Gas detector
- Battery charger, additional, 20 A
- Preparation for a second living area battery
- Coffee machine compartment, electrically adjustable
- Waste water electric valve drainage
- Gas regulator with antifreeze device and remote control

Pack value	1.680 €
Saving	-504 €

Pack price

1.176 €*

- (3) Allows to turn on / off the heating system via Bluetooth or GSM (SIM). The dedicated SIM is not provided by Laika.
- (7) In case this accessory is installed, the bathroom door will open at 90° instead at 180°.

WINTER PACK

+ 18,5 KG

- Heating, additional diesel heating
- Device permitting remote control of the heater via smartphone⁽³⁾

Pack value	3.361 €
Saving	-840 €

Pack price

2.520 €*

SUMMER PACK

+ 93,0 KG

- 2,200 W Air conditioning living area⁽⁷⁾
- External Shower (hot/cold water)
- Awning Laika, 4.5 m, grey housing
- 120 W Solar panel with control and fixing brackets

Pack value	4.117 €
Saving	-756 €

Pack price

3.361 €*

ACCESSORIES

Code No.	Accessories	Price €*	Kg	5009	5010
CHASSIS AND CAB					
AT9-140	Automatic transmission for engine 140 BHP (possible only with Eco Pack cod. OAA)	2.800 €	18,0 kg	O	O
AT9-160-180	Automatic transmission for engine 160 BHP and 180 BHP	2.800 €	3,0 kg	O	O
09U	Cab seats with seat heating, original Fiat part (2 pieces)	580 €	1,0 kg	O	O
5QD	Engine battery cut off switch, Fiat original part	50 €	0,0 kg	O	O
3056220	Engine Fiat 2.3, 160 BHP, Euro 6d Temp, including Eco Pack	1.780 €	15,0 kg	O	O
3056222	Engine Fiat 2.3, 180 BHP, Euro 6d Temp, including Eco Pack	3.280 €	15,0 kg	O	O
2560652	Fifth seat with removable seat	583 €	8,0 kg	O	O
75P	Fog lights, Fiat original part	243 €	0,6 kg	O	O
2013861	Laika logo stickers for Fiat wheel covers or alloy wheels (4 pieces)	32 €	0,1 kg	O	O
2112799	Suspensions, rear axle	2.892 €	45,0 kg	O	O

INTERIOR ACCESSORIES

2583029	22" TV LED DVD, with decoder and adjustable TV stand, rear area	795 €	7,5 kg	O	O
2458715	22" TV LED DVD, with decoder and adjustable TV stand, lounge right side	795 €	7,5 kg	O	O
2446750	Adjustable TV stand in rear area	671 €	1,3 kg	O	O
2843590	Bed in the lounge (single bed) with telescopic table leg	295 €	10,0 kg	O	O
2036097	Drop-down bed, electric, above the lounge	1.387 €	40,0 kg	O	O
63815	Kitchen "Grand Chef" version, 3 burners and integrated gas oven with grill ⁽⁴⁾	731 €	5,0 kg	O	O
2799662	Microwave oven (only possible in combination with the "Grand Chef" kitchen version)	375 €	2,5 kg	O	O
2289162	Rear double bed with ladder	259 €	5,0 kg	O	-
3105529	Rear double bed, electrically adjustable in height	1.270 €	25,0 kg	-	O
2582745	Shower with two removable shelves	115 €	3,2 kg	O	O

(*) Prices ex-works quoted without local VAT and without local taxes. Please note the information and explanations on the last page.

S = Standard

O = Option

– technically not possible

(4) With the "Grand Chef" kitchen, the standard gas oven above the fridge will no longer be available.

Code No.	Accessories	Price €*	Kg	5009	5010
2624650	Steps, 2 instead of 3, between the rear beds (no step volume protruding into the garage)	137 €	0,0 kg	O	-
2207339	Table with folding top and telescopic leg (bed in lounge not possible)	238 €	10,0 kg	O	O
2446769	TV stand, vertically adjustable and reclining, lounge area, right side	148 €	3,0 kg	O	O
EX	Upholstery Alba	383 €	0,0 kg	O	O
KE	Upholstery Noto	383 €	0,0 kg	O	O
TT2	Upholstery Udine	550 €	0,0 kg	O	O
KN	Upholstery Vip Club, real leather, made in Italy	2.366 €	4,0 kg	O	O

EXTERIOR ACCESSORIES

2599393	Additional fresh water tank 85 l, to be used in summer time	590 €	15,0 kg	O	O
2054611	Additional remote control for alarm	178 €	0,2 kg	O	O
2065675	Awning Laika, 4.5 m, grey housing	1.120 €	41,5 kg	O	O
37831	Bicycle rack, foldable, with 3 bike rails	330 €	9,3 kg	O	O
37832	Bike rack fourth holder	77 €	1,0 kg	O	O
3076985	Gas regulator	205 €	0,5 kg	O	O
2059062	Roof-light with electric ventilator, kitchen, white cover	128 €	2,0 kg	O	O
2390009	Roof-light with electric ventilator, shower, white cover	128 €	2,0 kg	O	O
2059042	Roof-light with electric ventilator, washroom, white cover	128 €	2,0 kg	O	O
AN3	Satellite aerial 80 HD	1.950 €	17,0 kg	O	O
AN4	Satellite aerial 80 HD, Twin	2.041 €	17,0 kg	O	O
54105	Stabilising jacks with warning light (2 pieces)	424 €	11,0 kg	O	O
2713134	Tow hitch for Fiat Heavy chassis	1.354 €	36,0 kg	O	O
2607196	Video reversing camera with 7" colour screen	616 €	0,5 kg	O	O