

KOSMO MOTORHOMES



STANDARD KOSMO MOTORHOMES DATA

Standard chassis		Fiat Ducato 35 Light
Engine displacement	cc	2.287
Maximum power	kW (hp)	88 (120)
Towable mass ^(H)	kg	2,000
Fresh water tank capacity (antifreeze) ^(K)	l	90 + 20
Waste water recovery tank capacity	l	90
Hot air channeled heating system	kW	6



Model shown: Kosmo 909 L

EQUIPMENT



CHASSIS

- Fiat Ducato mechanics, Turbo Diesel Common Rail, Euro 6d Temp
- Front wheel drive
- Enlarged rear track
- Electronic Stability Control: ESP specific for campers, ABS, ASR, Hill Holder and Roll Over Mitigation
- Front and rear sway bar
- 6-speed + 1 manual gearbox
- Driver airbag
- 75 l diesel tank
- Driver door with electric window lift
- Exterior mirror in black, bus-type, heated, electrically adjustable (wide angle lens included) and integrated radio antenna
- Day lights, headlight levellers
- 12 V and USB outlet in cab (max 180 W)
- Bottle holder on dashboard
- Swivel cab seating with armrests, seatbelts, adjustable in height, backrest and fabric coordinated with living room
- Adjustable height steering wheel

DESIGN & BODYWORK

- Walls and roof highly insulated with EPS polystyrene foam, roof lined in hail protection fibreglass, aluminium external walls, anti-yellowing
- Fibreglass sub-floor for maximum resistance to gravel and weathering over time
- Driver's door in cab with safety lock in open position
- Automotive headlights, rear side skirts consisting of more pieces to make repair works easier
- High quality, flat frame windows with aluminium frame, blind and mosquito net
- Premium XL living space door with centralised closure, remote control, window, blind, storage compartment and sliding mosquito net
- Aluminium underbody skirts
- External LED light
- Centralised door closure with remote control
- Garage with 150 kg payload capacity, low floor with non-slip coating, lighting, heating, rails with load hooks that can be repositioned as required, power socket, double external and internal access door
- Front windshield, 1 piece, in fibreglass with integrated maxi opening roof-light

KITCHEN & BATHROOM

- Trivalent 140 L refrigerator with automatic energy source selection (AES)
- Scratch and fingerprint resistant kitchen and table tops
- Kitchen window design panel
- Laminate window cover panel
- Dark glass protection panels for kitchen walls
- High gloss white kitchen furniture with storage space and internal shelves with anti-fall edge
- Chromed sink in stainless steel with sink cover including chopping board that can also be used as an additional wall shelf (depending on the model)
- Indirect lighting under kitchen top
- 3-burner stove in stainless steel with tempered glass lid
- Automatic soft-close drawers
- Chrome metal spice rack shelf
- 230 V outlet in kitchen
- 40 x 40 cm roof-light in kitchen
- Toilet with swivel cup and removable cassette 18 litres (frost-resistant)
- Bathroom door can also be used to separate the rear bedroom from the lounge/kitchen area
- Possibility of toilet/shower fitting using the front hinged door and rear sliding door (909L, 912)
- Bathroom with wooden furniture, large washbasin unit, independent shower with thermoformed interior, separation through methacrylate doors, equipped column, porthole and retractable roof rack
- Large floor storage compartment

SYSTEMS

- 100% LED lighting
- Heating 6kW and boiler with heat distribution and ducting throughout the interior, including rear garage and driver's cabin
- Two USB outlets in the rear bedroom
- Area for recharging mobile phones and tablets at entrance: support compartment, double USB outlet
- Electrical system with automatic battery charger 18 A, maintenance-free high-performance service battery 95 A, on-board control panel with LED display
- Gas compartment for two 10 kg cylinders, steel gas pipes, safety isolating valves
- Internal potable water tank, 110 l capacity,

easily accessible for cleaning and inspection, high-capacity electric immersion water pump

INTERIOR & COMFORT

- Entrance area with large integrated step and courtesy handle
- Multi-level indirect lighting in driving cab and lounge
- Comfortable internal headroom (213 cm)
- Furniture design Pero Toscano
- Noto upholstery
- Hanging doors in glossy white design, metal handles and high quality mechanical components
- Living room with upholstery and home comforts, adjustable headrests and cushions with removable lining
- Face-to-face living for Kosmo 909L and 912
- Anti-condensation walls and ventilation in the furniture for an ideal spread of the heat generated by the heating system
- Ergonomic table with moving top and easy handling. Folding table top for Kosmo 909L and 912
- Maxi panoramic roof-light above the lounge (70x50 cm)
- Shoe compartment at living space entry
- Blinds insulated for windscreen and drivers cabin windows
- Front drop-down bed with slats and high comfort mattress, courtesy awning, roof-light with transparent dome, double reading lights, shelf and separation curtain for maximum privacy
- Area under drop-down bed with indirect light and reading lights
- Manually height-adjustable rear bed (Kosmo 912)
- Rear beds with wooden staves, high quality, breathable mattresses with machine washable stretch lining
- Adjustable reading lights on rear beds
- Roof-light with transparent dome above rear bedroom

STANDARD SETTINGS FOR:

- Tow hitch
- Reversing camera
- TV in living area

OVERVIEW OF ALL MODELS

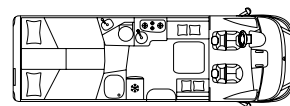
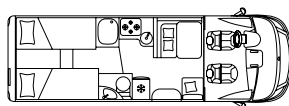

MODELS

909

909L

External length / width / height ^(D, E)	cm	741 / 233 / 290	741 / 233 / 290
Internal width / height	cm	218 / 213	218 / 213
Wheelbase	mm	4.035	4.035
Weight in running order ^(J)	kg	3.019	3.045
Payload (approx.) ^(F)	kg	481 ^S / 631 ^O	455 ^S / 605 ^O
Maximum total weight	kg	3.500 ^S / 3.650 ^O	3.500 ^S / 3.650 ^O
Type-approved seats ^(B)		4 ^S / 5 ^O	4 ^S
Wall / roof / floor (thickness)	mm	34 / 33 / 49	34 / 33 / 49
Garage dimensions (W x H x L)	cm	218 x 121 x 109	218 x 118 x 109
Right hatch / left hatch (W x H)	cm	93 x 115 / 93 x 115	93 x 115 / 93 x 115
Berths		4 ^S + 1 ^O	4 ^S + 1 ^O
Right side rear bed / left side rear bed	cm	207 x 80 / 200 x 80	205 x 80 / 210 x 80
Rear double bed	cm	O	O
Manually height-adjustable double rear bed with wooden staves	cm	-	-
Dinette bed	cm	200 x 115 ^O	200 x 115 ^O
Drop-down bed with wooden staves	cm	196 x 150	196 x 150
Refrigerator with automatic source selection and external inspection grid	l	140	140
Transparent roof-light in bathroom	cm	28 x 28	28 x 28
12 V sockets / 230 V sockets / USB socket		2 / 6 / (1+2)	1 / 5 / (1+2)
TV sockets in living room - rear bedroom		1 / -	1 / -

OPTIONAL

Optional Chassis		Fiat Ducato 43 Heavy	Fiat Ducato 43 Heavy
Maximum power	kW (hp)	103 (140), 117 (160), 130 (180)	103 (140), 117 (160), 130 (180)
Weight in running order ^(J)	kg	3.059	3.085
Payload (approx.) ^(F)	kg	1.191 ^S / 1.341 ^O	1.165 ^S / 1.315 ^O
Maximum total weight ^(C)	kg	4.250 ^S / 4.400 ^O	4.250 ^S / 4.400 ^O

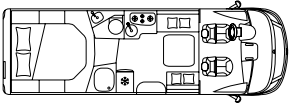

912

741 / 233 / 290

218 / 213

4.035

3.045

455^S / 605^O

3.500^S / 3.650^O

4^S

34 / 33 / 49

218 × 90^{min} / 120^{max} × 09

93 × 115 / 93 × 115

4^S + 1^O

- / -

-

190 × 148

200 × 115^O

196 × 150

140

28 × 28

1 / 5 / (1+2)

1 / -

Fiat Ducato 43 Heavy

103 (140), 117 (160), 130 (180)

3.085

1.165^S / 1.315^O

4.250^S / 4.400^O

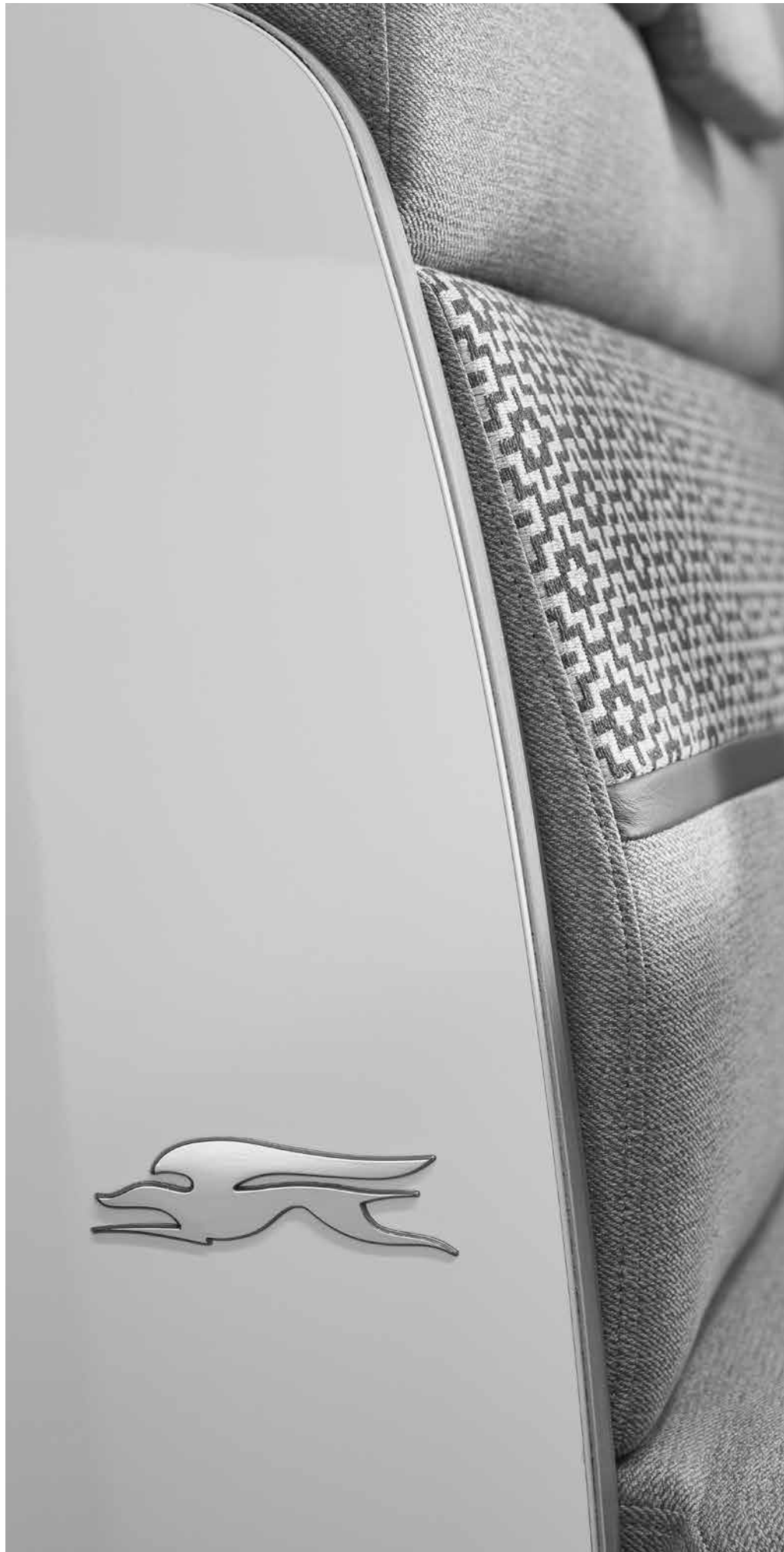

PACKS

CHASSIS PACK

+ 26,4 KG

- Manual single-zone air conditioning for cab, Fiat original part
- Traction+, Hill Descent
- Cruise control
- Steering wheel radio control
- Passengers airbag
- Steering wheel and gear lever in real leather, Fiat original part
- Dashboard display with chrome-coloured profile, Fiat original part
- Dashboard "Techno" with aluminium frames around warm air vents, Fiat original parts

Pack value	2.663 €
Saving	-647 €

Pack price **2.016 €***

COMFORT PACK

+ 12,5 KG

- Window in bathroom
- Shower with wooden footboard
- Carpet for driving cab and small carpet for internal step at entrance door
- Insulation for waste water tank

Pack value	744 €
Saving	-408 €

Pack price **335 €***

SAFETY PACK

+ 4,2 KG

- Parking sensors, front (4 pieces)
- Parking sensors, rear (4 pieces)
- "Antitheft system, volumetric and perimetric, with remote control integrated in the chassis key"
- Antitheft window sensors (6 pieces, only possible with anti-theft system)

Pack value	1.680 €
Saving	-504 €

Pack price **1.176 €***

MULTIMEDIA PACK

+ 7,8 KG

- 8" Multimedia System
- DAB radio
- Touchscreen
- Navigation system with 3 year subscription
- Rear camera
- Sound activators

Pack value	1.680 €
Saving	-168 €

Pack price **1.512 €***

(3) Allows to turn on / off the heating system via Bluetooth or GSM (SIM). The dedicated SIM is not provided by Laika.

SMART HOME PACK

+ 9,5 KG

- Gas detector
- Digital board control panel of heating system
- Heated and insulated waste water tank
- Gas regulator
- Adjustable TV stand entrance area/above fridge

Pack value	1.344€
------------	--------

Saving	-252 €
--------	--------

Pack price

1.092 € *

WINTER PACK

(AIR HEATING SYSTEM)

+ 13,0 KG

- Heating Combi 6E
- Heated floor (part of floor)
- Device permitting remote control of the heater via smartphone ⁽³⁾

Pack value	1.344 €
------------	---------

Saving	-504 €
--------	--------

Pack price

839 € *

SUMMER PACK

+ 74,0 KG

- 2,200 W Air conditioning living area
- External shower (cold water)
- Awning (manual) 5 m, exterior paint white

Pack value	3.192 €
------------	---------

Saving	-672 €
--------	--------

Pack price

2.520 € *

WINTER PACK

(WATER HEATING SYSTEM)

+ 67,0 KG

- Heating system, hot water heating
- Heated floor (part of floor)
- Device permitting remote control of the heater via smartphone ⁽³⁾

Pack value	3.269 €
------------	---------

Saving	-833 €
--------	--------

Pack price

2.436 € *

ACCESSORIES

Code No.	Accessories	Price €*	Kg	909	909L	912
CHASSIS AND CAB						
1LR	16" Alloy wheels Fiat original parts, Heavy chassis (4 pieces)	300 €	0,0 kg	O	O	O
431	16" Alloy wheels Fiat original parts, Light chassis, incl, 16" tyres (4 pieces)	450 €	12,0 kg	O	O	O
404	16" Tyres for Fiat Light chassis (total height of the vehicle is increased by 5 cm)	150 €	12,0 kg	O	O	O
140	Automatic Air conditioning for cab, Fiat original part (price difference on manual air conditioning)	406 €	0,0 kg	O	O	O
AT9-140	Automatic transmission for engine 140 BHP (possible only with Eco Pack cod, OAA), 16" tyres obligatory (see code 404)	2.800 €	48,0 kg	O	O	O
AT9-160-180	Automatic transmission for engine 160 BHP and 180 BHP, 16" tyres obligatory (see code 404)	2.800 €	33,0 kg	O	O	O
2734600	Chassis Fiat Heavy 4,250 kg	1.210 €	40,0 kg	O	O	O
2734602	Chassis Fiat Heavy 4,400 kg (possible only with 160 BHP or 180 BHP)	1.426 €	40,0 kg	O	O	O
3065127	Diesel tank 90 l, Fiat chassis	84 €	12,0 kg	O	O	O
OAA	Eco Pack Start & Stop function incl. booster (not in conjunction with 120 bhp, 140 bhp optional, 160 bhp and 180 bhp standard)	280 €	2,0 kg	O	O	O
5QD	Engine battery cut off switch, Fiat original part	50 €	0,0 kg	O	O	O
3057312	Engine Fiat 2,3, 140 BHP, Euro 6d Temp	650 €	0,0 kg	O	O	O
3056219	Engine Fiat 2,3, 160 BHP, Euro 6d Temp, including Eco Pack	2.430 €	15,0 kg	O	O	O
3056223	Engine Fiat 2,3, 180 BHP, Euro 6d Temp, including Eco Pack	3.930 €	15,0 kg	O	O	O
FD6	Fifth seat with removable seat	583 €	11,0 kg	O	-	-
2026176	Fog lights	335 €	2,0 kg	O	O	O
2043605	Increased weight 3,650 kg, Fiat Light chassis	217 €	0,0 kg	O	O	O
LED	LED headlights	1.000 €	2,0 kg	O	O	O
320	Steering wheel and gear lever in real leather, Fiat original part	248 €	0,3 kg	O	O	O
365	TPMS tyre pressure checking system	185 €	0,5 kg	O	O	O

INTERIOR ACCESSORIES

2989118	22" TV LED DVD, with decoder and adjustable TV stand, entrance area	867 €	7,5 kg	O	O	O
3171460	32" TV LED DVD, with decoder and adjustable TV stand, entrance area	1.175 €	10,3 kg	O	O	O
FD7	Bed in the lounge (single bed) with telescopic table leg	295 €	10,0 kg	O	O	O

(*) Prices ex-works quoted without local VAT and without local taxes. Please note the information and explanations on the last page.

S = Standard

O = Option

– technically not possible

Code No.	Accessories	Price €*	Kg	909	909L	912
FO	Gas oven with grill	530 €	17,0 kg	O	O	O
C30	Second battery for living area	263 €	27,0 kg	O	O	O
EX	Upholstery Alba	383 €	0,0 kg	O	O	O
EE	Upholstery Firenze, leatherette	550 €	0,0 kg	O	O	O
TT2	Upholstery Udine	550 €	0,0 kg	O	O	O
KN	Upholstery Vip Club, real leather, made in Italy	2.366 €	4,0 kg	O	O	O

EXTERIOR ACCESSORIES

2059419	120 W Solar panel with control and fixing brackets	726 €	15,5 kg	O	O	O
FF1	Awning (manual) 5 m, exterior paint white	1.184 €	37,5 kg	O	O	O
37831	Bicycle rack, foldable, with 3 bike rails	330 €	9,3 kg	O	O	O
37832	Bike rack fourth holder	77 €	1,0 kg	O	O	O
F44	External gas socket	193 €	1,0 kg	O	O	O
FE4	Motorcycle loading ramp and aluminium plate for garage floor protection	195 €	10,0 kg	O	O	O
AN3	Satellite aerial 80 HD	1.950 €	17,0 kg	O	O	O
F23	Stabilising jacks	251 €	6,0 kg	O	O	O
67201	Tow hitch	1.106 €	35,0 kg	O	O	O
2971001	Video reversing camera, infrared, with 7" colour screen	616 €	0,5 kg	O	O	O

